

# A6 RJC

Step inside a world of comfort and delight.

**RoyalJet**

---

BOMBARDIER GLOBAL

## A6RJC

These beautiful aircraft are two of the youngest in our fleet, having joined us fresh from the factory in 2015. Their interiors are classically designed, with a forward galley, a forward club four grouping, a mid-cabin conference arrangement and an aft VVIP lounge (majlis) with a VIP lavatory.

The interiors of these aircraft were developed utilizing premium materials such as high end leathers and beautiful wood veneers. They also incorporate state-of-the-art systems, including Swift Broadband WiFi, an iPad-controlled IFE System, mood lighting, and a high-quality sound system with overhead speakers and subwoofers.

These aircraft feature some of the lowest cabin altitudes in the industry, along with HEPA filters, which optimize health and comfort, leaving passengers more relaxed and fresh upon reaching their destination.

The cabin configuration offers 13 passenger seats, via the forward club four, mid cabin conference four and the aft 3 place divan across from the club two.

For overnight or for rest at any time of the flight, this aircraft offers a single sleeper divan, 4 VIP seats which recline up to 140°, and 6 seats with 110° recline.



## DAY CONFIGURATION

---

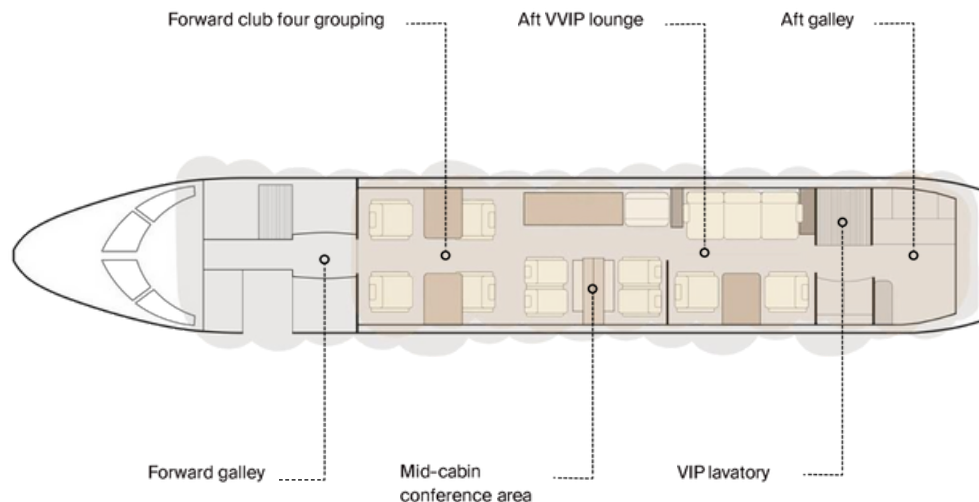

## FLEET TYPE

---

<b>REGISTRATION:</b>	A6RJC
<b>AIRCRAFT:</b>	Bombardier Global 5000 Vision
<b>YEAR OF MANUFACTURE:</b>	2014
<b>ENTRY INTO SERVICE:</b>	2015

## SPECIFICATIONS

---

<b>CONFIGURATION B:</b>	12 Seats, 10 VIP Seats, 2 on divan
<b>RANGE:</b>	11+ hours
<b>LUGGAGE CAPACITY:</b>	9-12 standard cases subject to weight and size
<b>ENTERTAINMENT:</b>	iPad-controlled IFE System, High-quality sound system with overhead speakers and subwoofers
<b>CONNECTIVITY:</b>	Swift Broadband WiFi, Cabin Satellite Phone, Fax
<b>OTHER:</b>	Low cabin altitude modification, HEPA filtration

## NIGHT CONFIGURATION

---

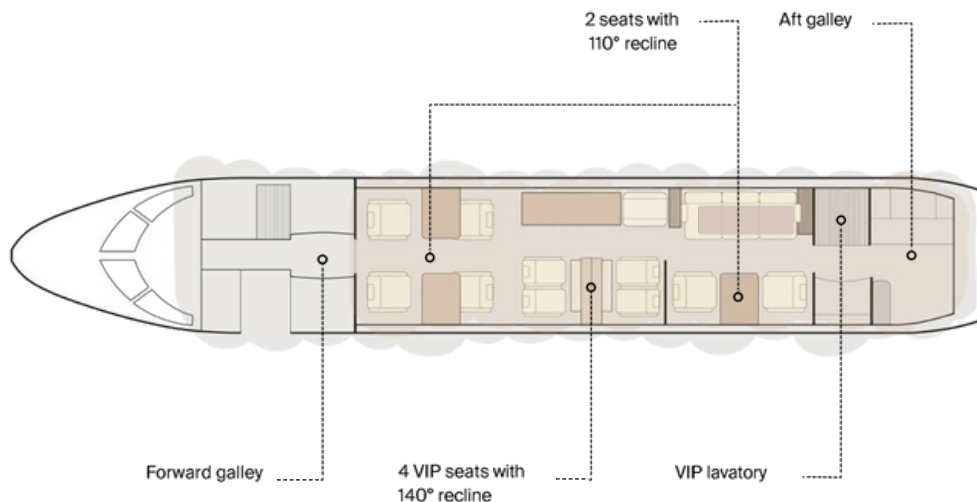

## FLEET TYPE

---

REGISTRATION:	A6RJC
AIRCRAFT:	Bombardier Global 5000 Vision
YEAR OF MANUFACTURE:	2014
ENTRY INTO SERVICE:	2015

## SPECIFICATIONS

---

SEAT TO BED:	 Single sleeper divan
SEAT RECLINE:	4 VIP seats with 140° recline 6 seats with 110° recline



**We look forward to  
welcoming you  
on board soon.**

**ROYALJET HEADQUARTERS**

Airport Area, Next to Presidential Flight  
Abu Dhabi, United Arab Emirates

[info@royaljetgroup.com](mailto:info@royaljetgroup.com) | +971 2 505 1520

**24 HOURS SALES**

[sales@royaljetgroup.com](mailto:sales@royaljetgroup.com) | +9712 5051500

ROYALJETGROUP.COM

---