

# A6 RJA

Step inside a world of comfort and delight.

**RoyalJet**

---

BOEING BUSINESS JET

# A6RJA

RoyalJet's latest acquisition – a Boeing Business Jet – was acquired by the company in early 2022 and is now ready for charter after undergoing upgrades and technology enhancements in Basel, Switzerland over the past few months.

This BBJ boasts 19 passenger VVIP interior with a forward crew rest area, master bedroom with private lavatory and shower, and a mid-cabin open-plan lounge. It has been finished with custom-made materials and state-of-the-art design configuration for best functionality and maximum comfort. The cabin can also sleep up to 12 in VVIP lie-flat seats and its queen-sized bed.

The aircraft was upgraded with special soundproofing to reduce in-flight noise levels, along with a low cabin altitude modification, special humidifiers, and a HEPA filtration system. All designed to optimize the health and comfort of our VIPs, meaning passengers will be more relaxed and fresher upon reaching their destination.

To further enhance the on board experience this aircraft is fitted with the latest technology and the best connectivity available in the market. This includes the very latest lighting, cabin management, and in-flight entertainment systems, complemented by a high-quality sound system including overhead speakers and subwoofers.

This aircraft is the longest-range BBJ in RoyalJet fleet, with auxiliary fuel tanks giving it the capability to fly non-stop for more than 12 hours and reach almost any destination globally with only one short fuel stop.



## DAY CONFIGURATION

---

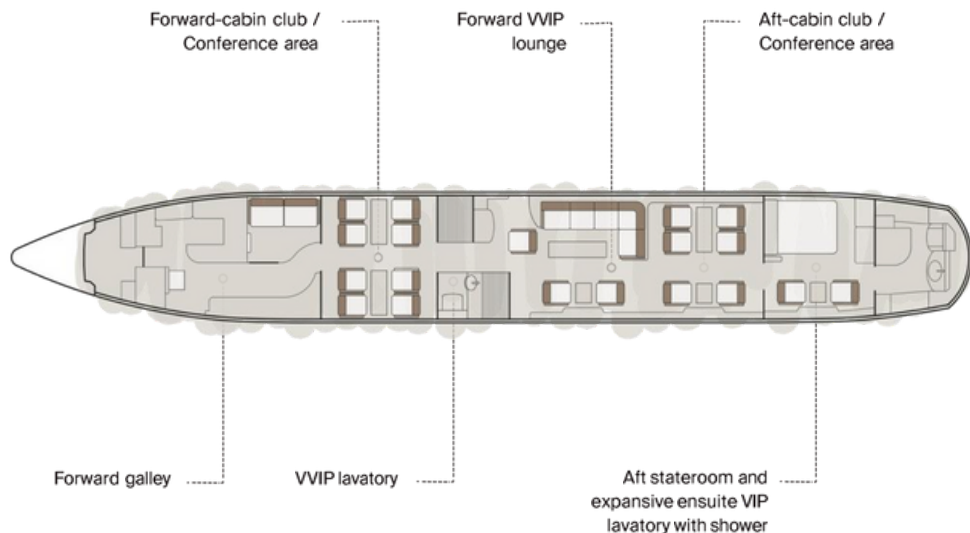

## FLEET TYPE

---

<b>REGISTRATION:</b>	A6RJA
<b>AIRCRAFT:</b>	Boeing BBJ-737-700
<b>ENTRY INTO SERVICE:</b>	2011

## SPECIFICATIONS

---

<b>CONFIGURATION:</b>	19 Seats, , 1 Bedroom (rear); 17 VIP, 2 on divan
<b>RANGE:</b>	12+ hours
<b>LUGGAGE CAPACITY:</b>	14-16 suitcases subject to weight and size
<b>ENTERTAINMENT:</b>	Airshow 410, Dual 21.3-inch monitors, three 37-inch monitors, State-of-the-art iPad-controlled IFE System
<b>CONNECTIVITY:</b>	Ka-Band WiFi, Cabin Satellite Phone
<b>OTHER:</b>	Low cabin altitude modification, Manual Full Room Humidifiers

## NIGHT CONFIGURATION

---

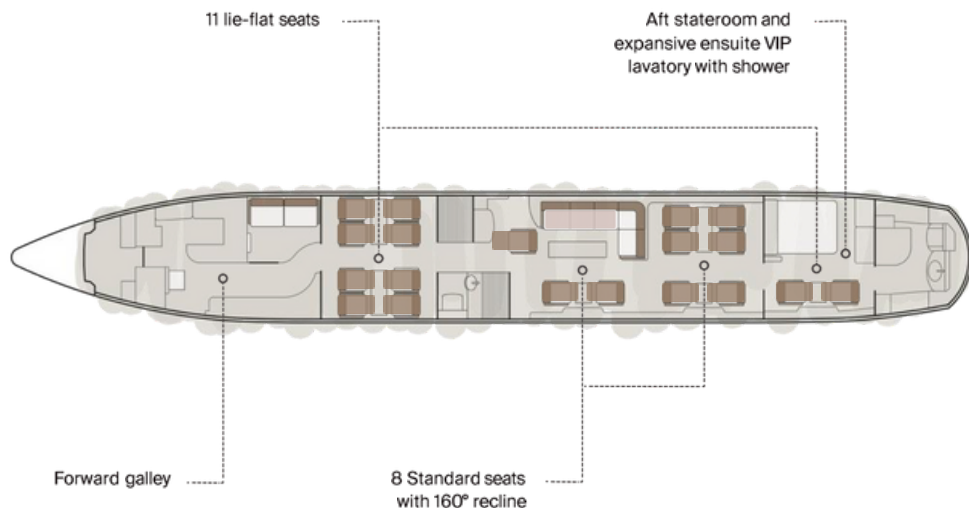

## FLEET TYPE

---

REGISTRATION:	A6RJA
AIRCRAFT:	Boeing BBJ 737-700
ENTRY INTO SERVICE:	2011

## SPECIFICATIONS

---

BEDROOM:	1 Bedroom (back)
SEAT TO BED:	 11 lie-flat seats
	 1 single sleeper divan
SEAT RECLINE:	8 Standard seats with 160° recline



**We look forward to  
welcoming you  
on board soon.**

**ROYALJET HEADQUARTERS**

Airport Area, Next to Presidential Flight  
Abu Dhabi, United Arab Emirates

[info@royaljetgroup.com](mailto:info@royaljetgroup.com) | +971 2 505 1520

**24 HOURS SALES**

[sales@royaljetgroup.com](mailto:sales@royaljetgroup.com) | +9712 5051500

ROYALJETGROUP.COM

---