

# **A6 AIN**

Step inside a world of comfort and delight.

**RoyalJet<sup>®</sup>**

---

BOEING BUSINESS JET

# A6 AIN

This beautiful recently upgraded aircraft offers a VVIP interior which includes a forward stateroom and ensuite VIP lavatory, forward and aft galleys, club/conference seating and a VIP lounge (majlis) mid-cabin, and aft business class and standard class seating.

A full interior refurbishment was done on this aircraft in 2014 using premium materials such as Ostrich skin and high gloss wood veneer. It also features a state-of-the-art iPad-controlled IFE System, a high-quality sound system which includes overhead speakers and subwoofers, and HEPA filtration which optimize passenger health and comfort.

In late 2020, further interior touch-ups were completed and communications were upgraded to the latest and highest speed system (Ka-Band WiFi) available globally. This system allows for streaming of high definition video content, including via passengers' own accounts with providers such as Apple TV, Netflix, and Amazon Prime Video.

The cabin configuration offers flexibility between lower density (36 pax), or higher density (46 pax) depending on the client's preference and mission profile, and the aircraft is also capable of being converted into Medevac configuration via the installation of up to three ICU modules.

For a restful and comfortable trip overnight or at any time of the flight, this aircraft offers a queen-sized bed, 4 lie-flat seats and up to 24 seats reclinable to 140°.



## DAY CONFIGURATION

---

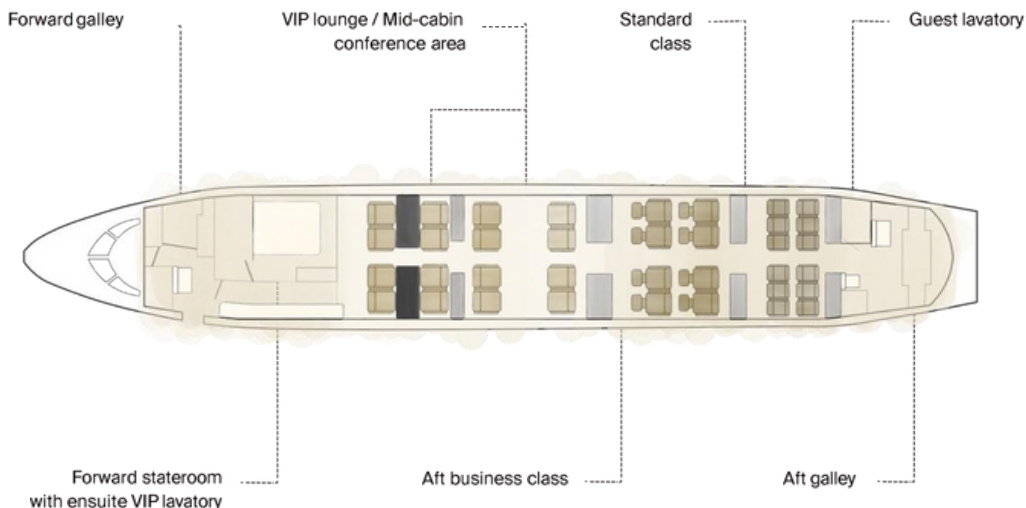

## FLEET TYPE

---

<b>REGISTRATION:</b>	A6 AIN
<b>AIRCRAFT:</b>	Boeing Business Jet 737-700
<b>YEAR OF MANUFACTURE:</b>	1999
<b>REFURBISHED:</b>	2014

## SPECIFICATIONS

---

<b>CONFIGURATION A:</b>	36 Seats, 1 Bedroom (front); 16 VIP, 8 Business, 12 Standard
<b>RANGE:</b>	9.5+ hours
<b>LUGGAGE CAPACITY:</b>	52-60 suitcases subject to weight and size
<b>ENTERTAINMENT:</b>	State-of-the-art iPad-controlled IFE System, High-quality sound system with overhead speakers and subwoofers
<b>CONNECTIVITY:</b>	Ka-Band WiFi, GSM Phone, Cabin Satellite Phone, Fax
<b>OTHER:</b>	HEPA filtration

## NIGHT CONFIGURATION

---

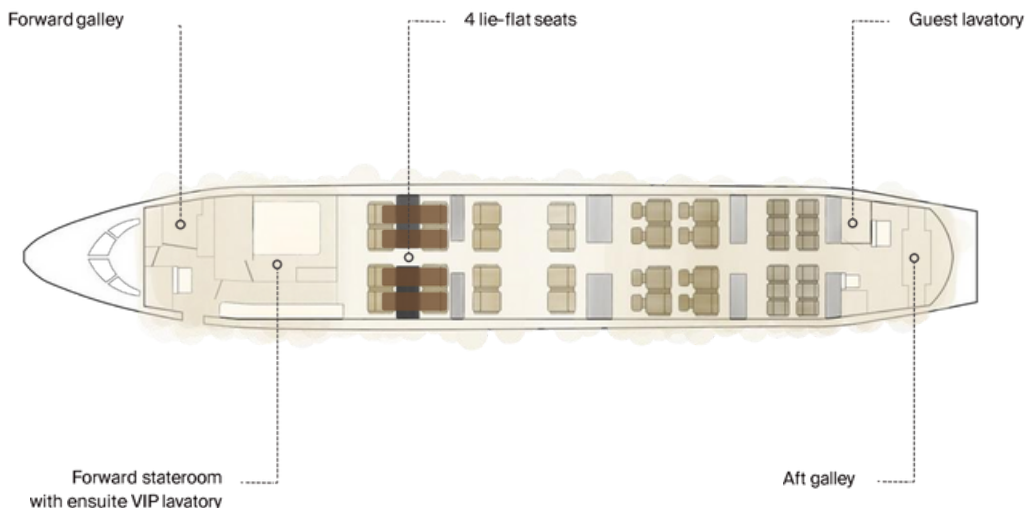

## FLEET TYPE

---

<b>REGISTRATION:</b>	A6 AIN
<b>AIRCRAFT:</b>	Boeing Business Jet 737-700
<b>YEAR OF MANUFACTURE:</b>	1999
<b>REFURBISHED:</b>	2014

## SPECIFICATIONS

---

<b>BEDROOM:</b>	1 Bedroom (front)
<b>SEAT TO BED:</b>	 8 seats to 4 beds via 4 lie-flat seats
<b>SEAT RECLINE:</b>	16 Business seats with 140° recline 12 Standard seats with 45° recline with no foot rest

## DAY CONFIGURATION

---

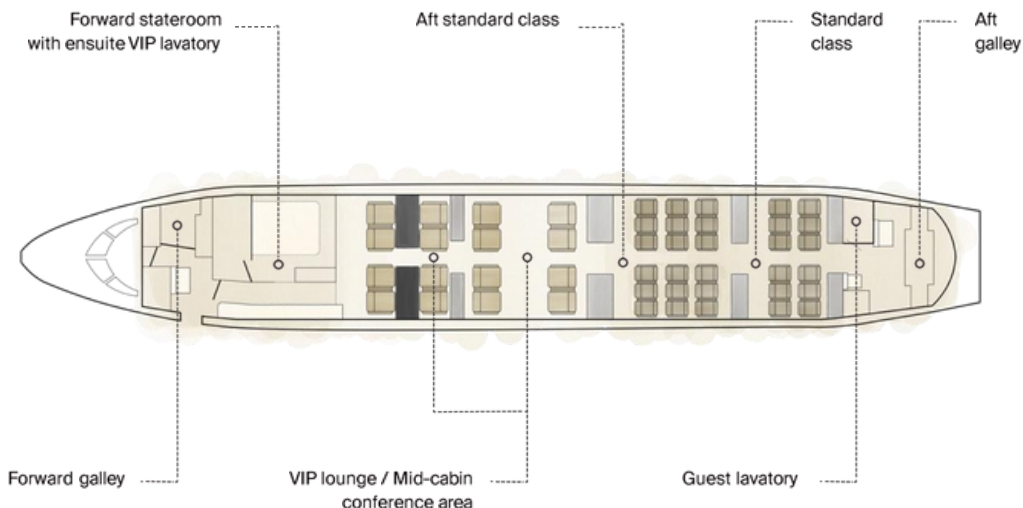

## FLEET TYPE

---

<b>REGISTRATION:</b>	A6 AIN
<b>AIRCRAFT:</b>	Boeing Business Jet 737-700
<b>YEAR OF MANUFACTURE:</b>	1999
<b>REFURBISHED:</b>	2014

## SPECIFICATIONS

---

<b>CONFIGURATION B:</b>	46 Seats, 1 Bedroom (front); 16 VIP, 30 Standard
<b>RANGE:</b>	9.5+ hours
<b>LUGGAGE CAPACITY:</b>	52-60 suitcases subject to weight and size
<b>ENTERTAINMENT:</b>	State-of-the-art iPad-controlled IFE System, High-quality sound system with overhead speakers and subwoofers
<b>CONNECTIVITY:</b>	Ka-Band WiFi, GSM Phone, Cabin Satellite Phone, Fax
<b>OTHER:</b>	HEPA filtration

## NIGHT CONFIGURATION

---

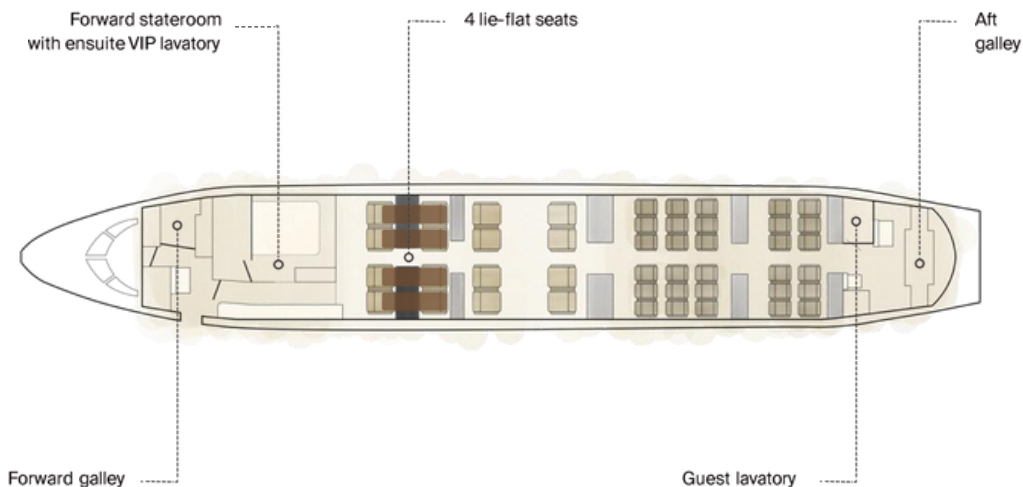

## FLEET TYPE

---

REGISTRATION:	A6 AIN
AIRCRAFT:	Boeing Business Jet 737-700
YEAR OF MANUFACTURE:	1999
REFURBISHED:	2014

## SPECIFICATIONS

---

BEDROOM:	1 Bedroom (front)
SEAT TO BED:	 8 seats to 4 beds via 4 lie-flat seats
SEAT RECLINE:	8 Business seats with 140° recline 30 Standard seats with 45° recline with no foot rest



**We look forward to  
welcoming you  
on board soon.**

**ROYALJET HEADQUARTERS**

Airport Area, Next to Presidential Flight  
Abu Dhabi, United Arab Emirates

[info@royaljetgroup.com](mailto:info@royaljetgroup.com) | +971 2 505 1520

**24 HOURS SALES**

[sales@royaljetgroup.com](mailto:sales@royaljetgroup.com) | +9712 5051500

ROYALJETGROUP.COM

---