

Our Fleet Guide

Step inside a world of comfort and delight.

RoyalJet



Contents

02	ABOUT ROYALJET
04	OUR FLEET
05	OUR FBO
06	BOEING BUSINESS JETS
07	A6 RJF
11	A6 RJA
15	A6 RJU
19	A6 RJV
23	A6 DAS
29	A6 AIN
35	A6 RJZ
41	A6 RJK
49	BOMBARDIER GLOBAL
50	A6 RJC
54	A6 RJD
58	MEDICAL EVACUATION
59	THE PIONEER OF AEROMEDICAL EVACUATION IN THE MIDDLE EAST
60	MEDEVAC CONFIGURATIONS

About RoyalJet

Royal Jet LLC is an Abu Dhabi-owned company that leads the global premium private aviation sector and is chaired by His Excellency Mohammed Bin Mahfoodh Alardhi.

With its headquarters in Abu Dhabi in the United Arab Emirates, RoyalJet operates from its Fixed Based Operations (FBO) / VIP Terminal at Zayed International Airport. The company and its employees hold multiple certifications and licenses issued by the UAE General Civil Aviation Authority and the Republic of San Marino Civil Aviation Authority.

Royal Jet LLC, through its Abu Dhabi and San Marino entities, owns and/or operates 10 Boeing Business Jets and five Bombardier Global 5000/6000/7500 aircraft, offering aircraft management, aircraft charter, aircraft leasing, medical evacuation flights, aircraft brokerage, flight support services, FBO services, aircraft maintenance, repair and CAMO services, aircraft acquisition and disposal services and VIP aviation consulting.





Royal Jet LLC is a founding member of the Middle East Business Aviation Association (MEBAA) and a member of various other industry associations. Its flight and ground operations are certified by the International Business Aviation Council (IBAC) and the Wyvern Wingman program. Additionally, its FBO is also a member of the leading Air Elite Network.

RoyalJet LLC is also a proud multiple-times winner of the "World's Leading Private Jet Charter" category at the annual World Travel Awards and its FBO has won numerous awards for its facilities and services.



Our Fleet

The RoyalJet award winning charter fleet features flexibility and choice unparalleled in premium private aviation. We operate by far the largest fleet in the world of Boeing Business Jets - the leading VIP airliner on the market - and with 10 spectacular aircraft of this type available for charter, we can deliver various configurations to suit your needs. We also operate five beautiful Bombardier Global 5000,6000/7500 aircraft - the leading private jet in its class - for your smaller groups and specific missions.



Our FBO

An FBO experience for people - and from people - we believe that whether you're travelling private, business class, or first class, you deserve to have a luxurious experience from start to finish.





Boeing Business Jets

BOEING BUSINESS JET

A6 RJF

The RJF, RoyalJet's latest acquisition, boasts 19 passenger VVIP interior with a forward crew rest area, an aft stateroom with expansive ensuite VIP lavatory and shower, and a first-class lounge. Finished with custom-made materials and state-of-the-art design configuration, the BBJ is designed for the best functionality and maximum comfort.

The BBJ's first-class lounge area is equipped with a custom liner system, CMS-controlled electric window shades, VIP-style custom carpet, LED reading, table lights, and wash lighting with customized mood presets among others.

It also has a 32-inch monitor, cabinets with two pullout tables on each side, hanging storage, and active emergency exits on both sides.

The aft stateroom is fitted with CMS-controlled electric window shades, VIP-style custom carpet, wash lighting, and a 42-inch monitor.

There's also the under-bed storage, a nightstand with storage, and a full-height closet with storage among others. In the rear of the plane is the expansive ensuite VIP lavatory complete with a rectangular shower.

The BBJ has spacious cabins with luxurious amenities such as fully reclining seats, and a private sleeping area, and is designed to fly at high speeds with long-range capacity, allowing it to cover long distances quickly and efficiently. The BBJ is built to the highest safety standards and has been tested to ensure its reliability.



DAY CONFIGURATION

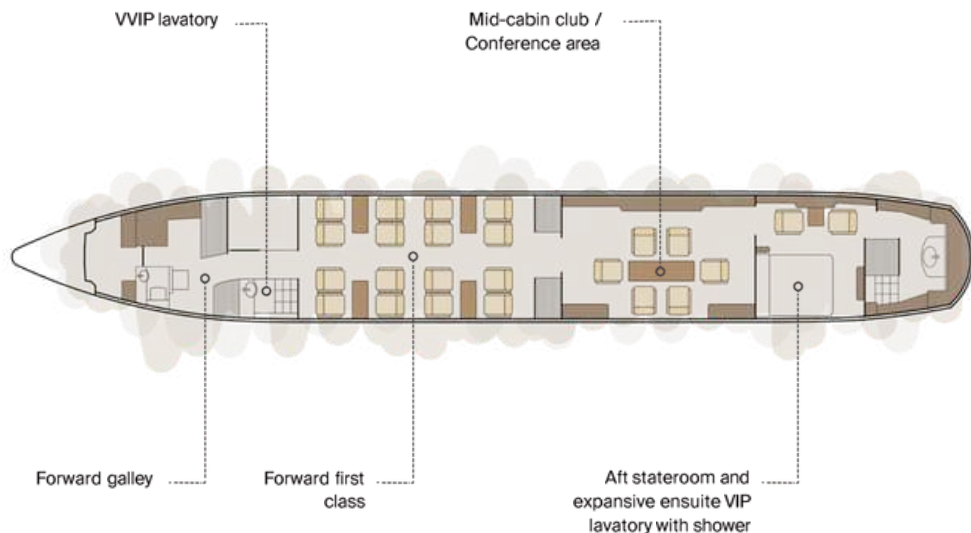

FLEET TYPE

REGISTRATION:	A6 RJF
AIRCRAFT:	Boeing BBJ 737-700
ENTRY INTO SERVICE:	2018

SPECIFICATIONS

CONFIGURATION:	19 Seats, 1 Bedroom (rear)
RANGE:	12+ hours
LUGGAGE CAPACITY:	23-25 suitcases subject to weight and size
ENTERTAINMENT:	42-inch monitor, 32-inch monitor
CONNECTIVITY:	Ka-Band WiFi, Cabin Satellite Phone
OTHER:	Low cabin altitude modification, Integral forward airstairs, CMS controlled electric window shades

NIGHT CONFIGURATION

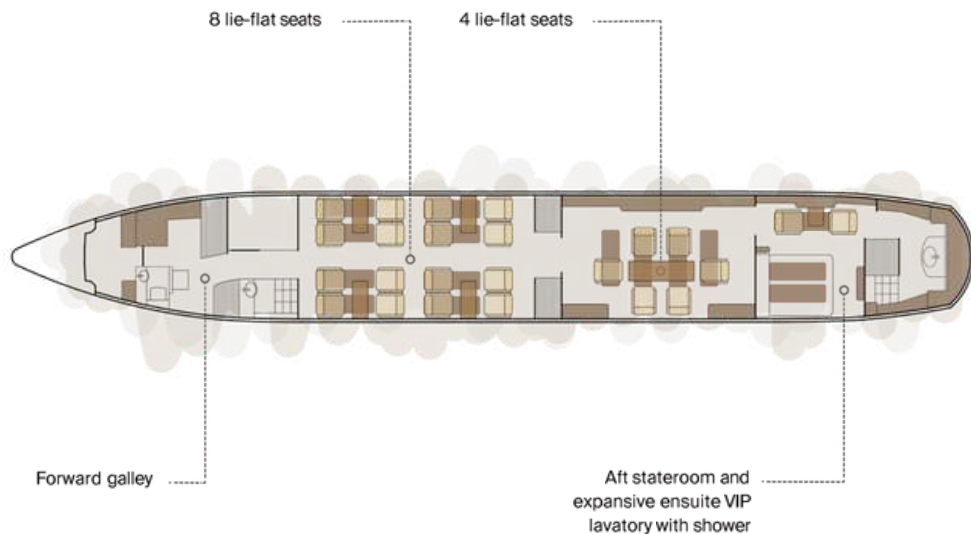

FLEET TYPE

<i>REGISTRATION:</i>	A6RJF
<i>AIRCRAFT:</i>	Boeing BBJ 737-700
<i>ENTRY INTO SERVICE:</i>	2018

SPECIFICATIONS

<i>BEDROOM:</i>	1 Bedroom (back)
<i>SEAT TO BED:</i>	 13 lie-flat seats

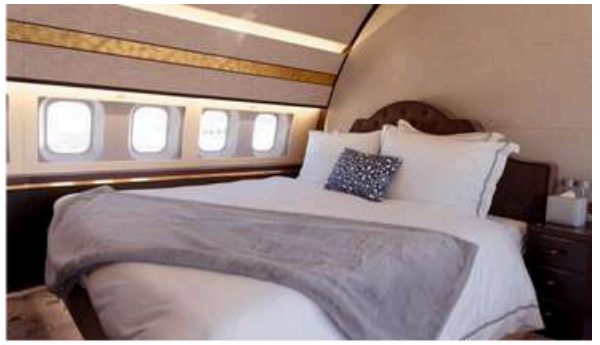

BOEING BUSINESS JET

A6RJA

RoyalJet's latest acquisition – a Boeing Business Jet – was acquired by the company in early 2022 and is now ready for charter after undergoing upgrades and technology enhancements in Basel, Switzerland over the past few months.

This BBJ boasts 19 passenger VVIP interior with a forward crew rest area, master bedroom with private lavatory and shower, and a mid-cabin open-plan lounge. It has been finished with custom-made materials and state-of-the-art design configuration for best functionality and maximum comfort. The cabin can also sleep up to 12 in VVIP lie-flat seats and its queen-sized bed.

The aircraft was upgraded with special soundproofing to reduce in-flight noise levels, along with a low cabin altitude modification, special humidifiers, and a HEPA filtration system. All designed to optimize the health and comfort of our VIPs, meaning passengers will be more relaxed and fresher upon reaching their destination.

To further enhance the on board experience this aircraft is fitted with the latest technology and the best connectivity available in the market. This includes the very latest lighting, cabin management, and in-flight entertainment systems, complemented by a high-quality sound system including overhead speakers and subwoofers.

This aircraft is the longest-range BBJ in RoyalJet fleet, with auxiliary fuel tanks giving it the capability to fly non-stop for more than 12 hours and reach almost any destination globally with only one short fuel stop.



DAY CONFIGURATION

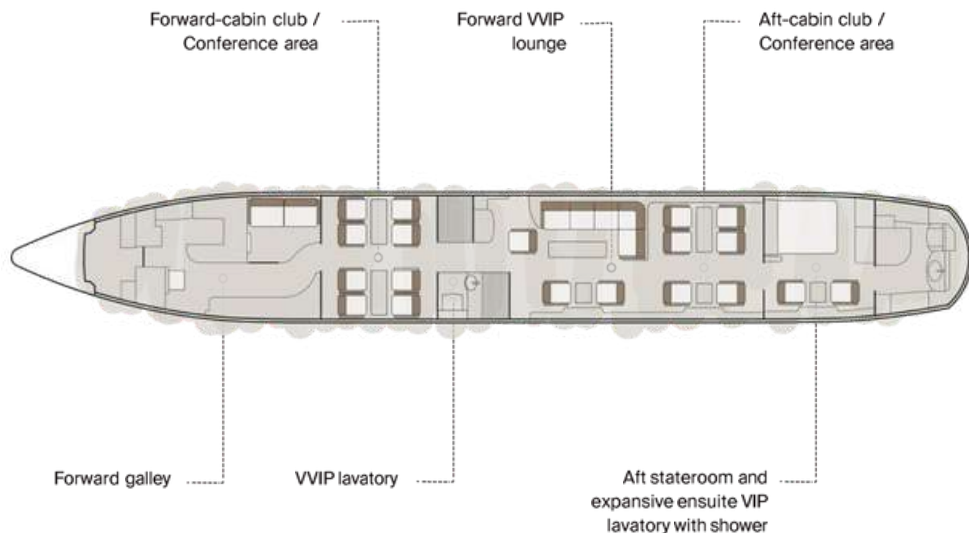

FLEET TYPE

REGISTRATION:	A6RJA
AIRCRAFT:	Boeing BBJ-737-700
ENTRY INTO SERVICE:	2011

SPECIFICATIONS

CONFIGURATION:	19 Seats, , 1 Bedroom (rear); 17 VIP, 2 on divan
RANGE:	12+ hours
LUGGAGE CAPACITY:	14-16 suitcases subject to weight and size
ENTERTAINMENT:	Airshow 410, Dual 21.3-inch monitors, three 37-inch monitors, State-of-the-art iPad-controlled IFE System
CONNECTIVITY:	Ka-Band WiFi, Cabin Satellite Phone
OTHER:	Low cabin altitude modification, Manual Full Room Humidifiers

NIGHT CONFIGURATION

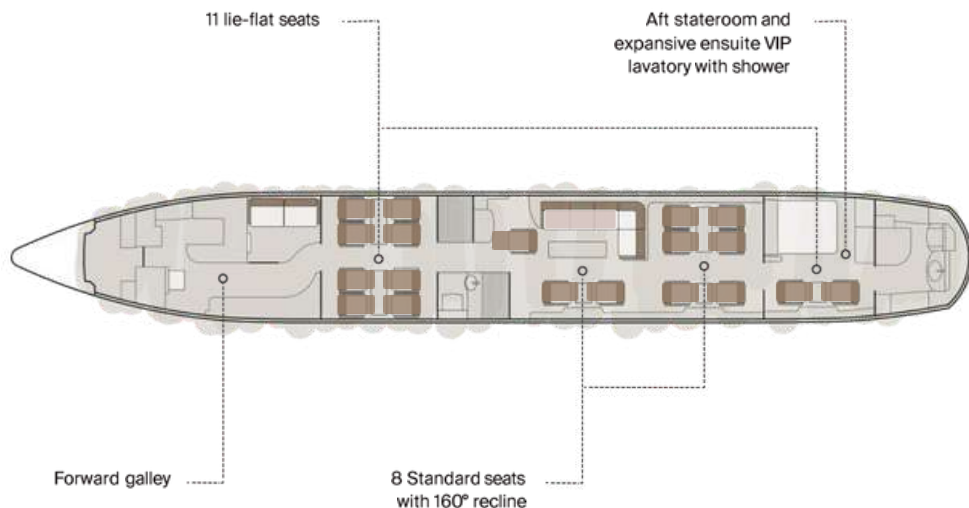

FLEET TYPE

<i>REGISTRATION:</i>	A6RJA
<i>AIRCRAFT:</i>	Boeing BBJ 737-700
<i>ENTRY INTO SERVICE:</i>	2011

SPECIFICATIONS

<i>BEDROOM:</i>	1 Bedroom (back)
<i>SEAT TO BED:</i>	 11 lie-flat seats
	 1 single sleeper divan
<i>SEAT RECLINE:</i>	8 Standard seats with 160° recline



BOEING BUSINESS JET

A6 RJU

This aircraft is one of the newest in our fleet, having joined us fresh from the factory in 2017, and offers a forward stateroom with ensuite VIP lavatory, forward and aft galleys, a mid-cabin club / conference area, aft business class, and standard class seating.

The contemporary design of this aircraft features carbon fiber and premium materials throughout the cabin, along with a unique cool mood lighting system with over a million color variations, which is controlled by the customer operated iPad-based cabin management system.

This aircraft also boasts a state-of-the-art video-on-demand IFE System, enhanced by our high-quality sound system with overhead speakers and subwoofers, which can be controlled by the RoyalJet provided iPads or via the customer's own device. To maximize the value of this system for our guests, the aircraft has also been equipped with the highest speed communications system (Ka-Band WiFi) available globally. This system allows passengers to stream high definition video content throughout the flight, including via their own personal account with providers such as Apple TV, Netflix, and Amazon Prime Video.

A low cabin altitude modification and HEPA filtration are also featured, which optimize health and comfort, leaving passengers more relaxed and fresher upon reaching their destination.

The cabin configuration offers 34 seats via the mid cabin club eight arrangement, the eight mid/aft business class seats and the 18 aft standard class seats. For overnight or at any time of the flight, this aircraft features a queen-sized bed and 16 lie-flat seats.



DAY CONFIGURATION

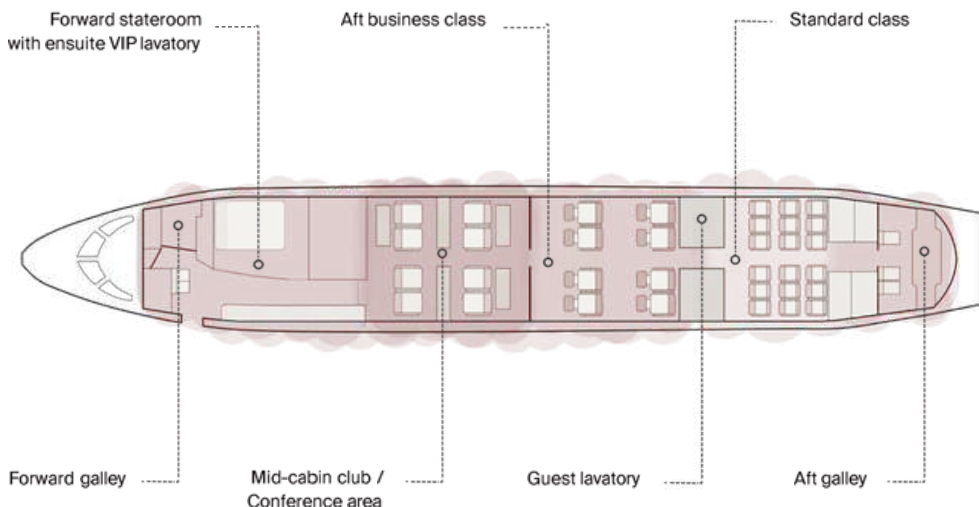

FLEET TYPE

REGISTRATION:	A6RJU
AIRCRAFT:	Boeing Business Jet 737-700
YEAR OF MANUFACTURE:	2015
ENTRY INTO SERVICE:	2016

SPECIFICATIONS

CONFIGURATION:	34 Seats, Bedroom (front); 8 VIP, 8 Business, 18 Standard
RANGE:	10+ hours
LUGGAGE CAPACITY:	51-55 suitcases subject to weight and size
ENTERTAINMENT:	Video-on-demand IFE System, High-quality sound system with overhead speakers and subwoofers, World Map
CONNECTIVITY:	Ka-Band WiFi, GSM Phone, Cabin Satellite Phone, Fax
OTHER:	Low cabin altitude modification, HEPA filtration

NIGHT CONFIGURATION

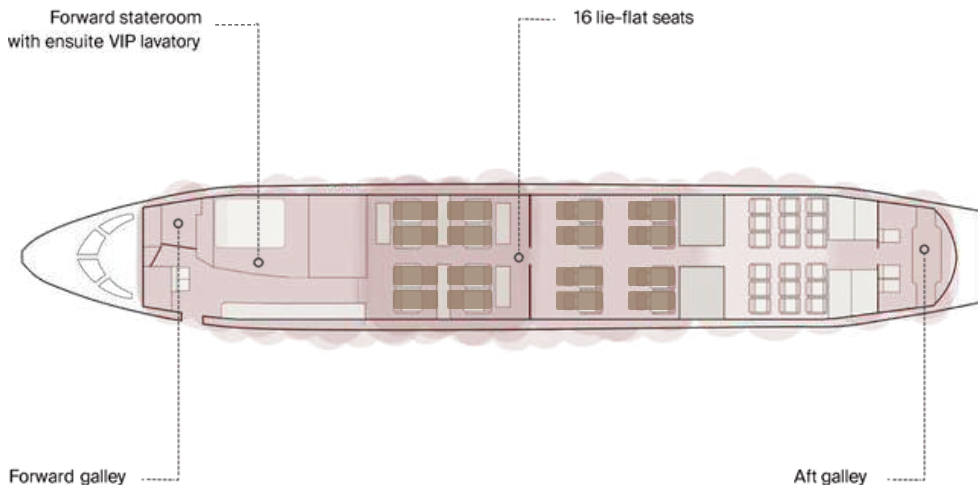

FLEET TYPE

<i>REGISTRATION:</i>	A6 RJU
<i>AIRCRAFT:</i>	Boeing Business Jet 737-700
<i>YEAR OF MANUFACTURE:</i>	2015
<i>ENTRY INTO SERVICE:</i>	2016

SPECIFICATIONS

<i>BEDROOM:</i>	1 Bedroom (front)
<i>SEAT TO BED:</i>	 16 lie-flat seats
<i>SEAT RECLINE:</i>	18 Standard seats with 45° recline with no foot rest

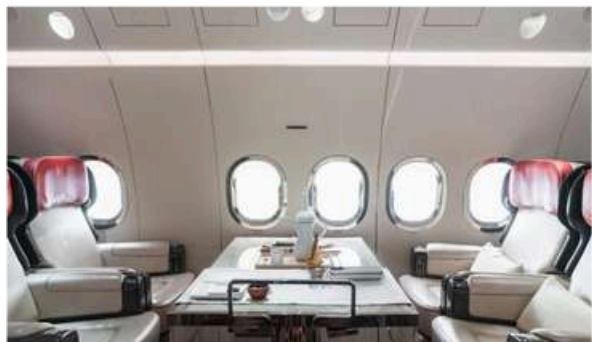
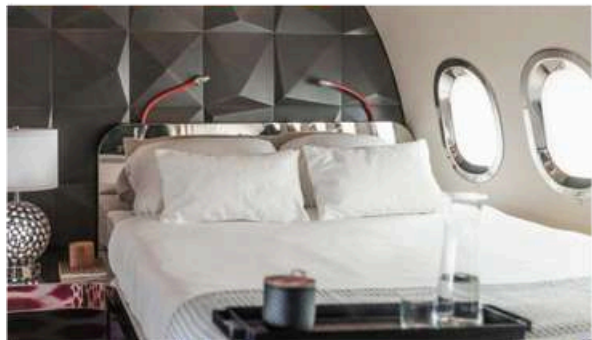

BOEING BUSINESS JET

A6RJV

This aircraft is one of the newest in our fleet, having joined us fresh from the factory in 2017, and offers a forward stateroom with ensuite VIP lavatory, forward and aft galleys, a mid-cabin club / conference area, aft business class, and standard class seating.

The contemporary design of this aircraft features carbon fiber and premium materials throughout the cabin, along with a unique cool mood lighting system with over a million color variations, which is controlled by the customer operated iPad-based cabin management system.

This aircraft also boasts a state-of-the-art video-on-demand IFE System, enhanced by our high-quality sound system with overhead speakers and subwoofers, which can be controlled by the RoyalJet provided iPads or via the customer's own device. To maximize the value of this system for our guests, the aircraft has also been equipped with the highest speed communications system (Ka-Band WiFi) available globally. This system allows passengers to stream high definition video content throughout the flight, including via their own personal account with providers such as Apple TV, Netflix, and Amazon Prime Video.

A low cabin altitude modification and HEPA filtration are also featured, which optimize health and comfort, leaving passengers more relaxed and fresher upon reaching their destination.

The cabin configuration offers 34 seats via the mid cabin club eight arrangement, the eight mid/aft business class seats and the 18 aft standard class seats. For overnight or at any time of the flight, this aircraft features a queen-sized bed and 16 lie-flat seats.



DAY CONFIGURATION

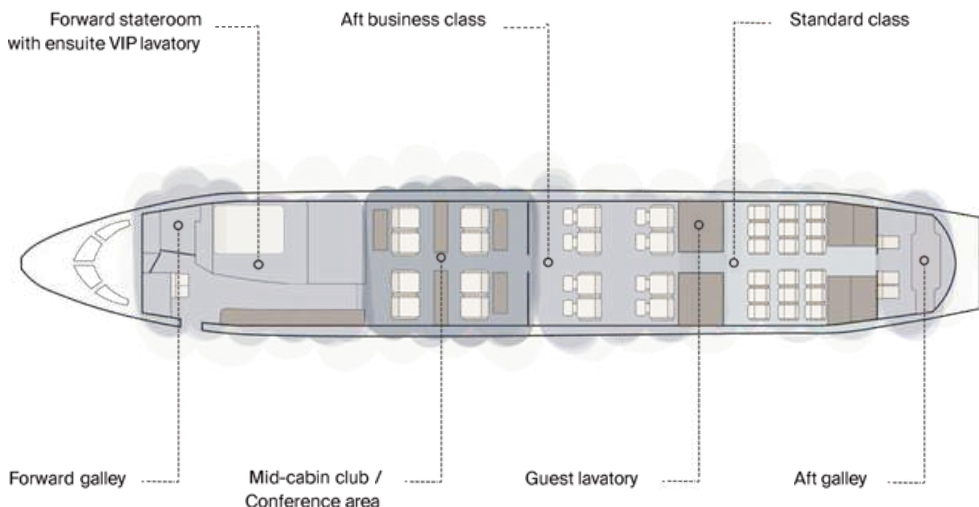

FLEET TYPE

REGISTRATION:	A6RJV
AIRCRAFT:	Boeing Business Jet 737-700
YEAR OF MANUFACTURE:	2015
ENTRY INTO SERVICE:	2016

SPECIFICATIONS

CONFIGURATION:	34 Seats, Bedroom (front); 8 VIP, 8 Business, 18 Standard
RANGE:	10+ hours
LUGGAGE CAPACITY:	51-55 suitcases subject to weight and size
ENTERTAINMENT:	Video-on-demand IFE System, High-quality sound system with overhead speakers and subwoofers, World Map
CONNECTIVITY:	Ka-Band WiFi, GSM Phone, Cabin Satellite Phone, Fax
OTHER:	Low cabin altitude modification, HEPA filtration

NIGHT CONFIGURATION

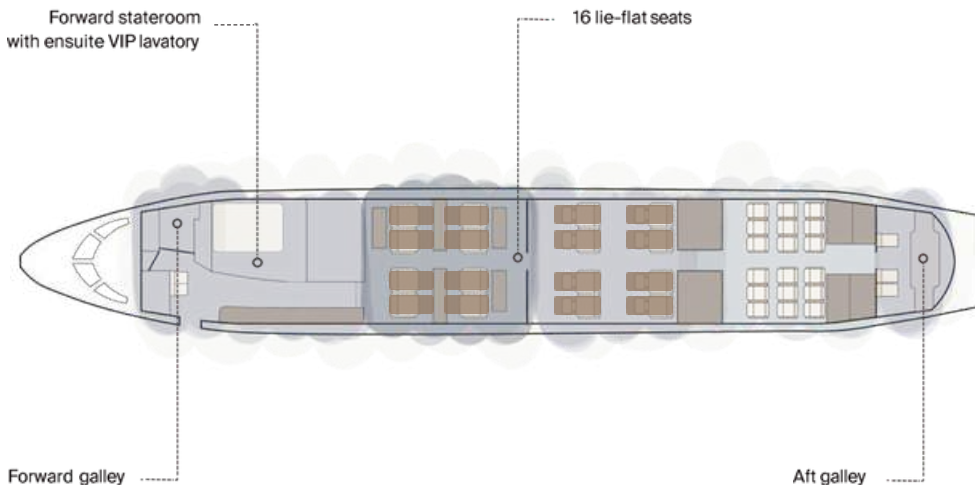

FLEET TYPE

<i>REGISTRATION:</i>	A6RJV
<i>AIRCRAFT:</i>	Boeing Business Jet 737-700
<i>YEAR OF MANUFACTURE:</i>	2015
<i>ENTRY INTO SERVICE:</i>	2016

SPECIFICATIONS

<i>BEDROOM:</i>	1 Bedroom (front)
<i>SEAT TO BED:</i>	 16 lie-flat seats
<i>SEAT RECLINE:</i>	18 Standard seats with 45° recline with no foot rest

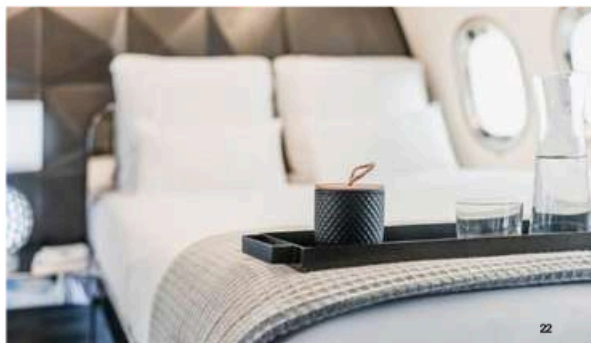

BOEING BUSINESS JET

A6 DAS

This freshly refurbished and spectacular aircraft offers a **VVIP** interior which includes a forward stateroom with ensuite **VIP** lavatory, forward and aft galleys, club / conference seating and a **VIP** lounge (majlis) mid-cabin, aft business class, and standard class seating.

A comprehensive interior refurbishment was just completed on A6 DAS in 2021, utilizing state of the art materials and a design that reflects the culture and identity of Abu Dhabi and the UAE. This brand-new interior represents the launch of the RoyalJet customer experience transformation and features the very latest lighting, cabin management and in-flight entertainment systems which are complimented by a high-quality sound system including overhead speakers and subwoofers.

The aircraft has also been equipped with the highest speed communications system (Ka-Band WiFi) available globally, which allows passengers to stream high definition video content throughout the flight, including via their own personal accounts with providers such as Apple TV, Netflix and Amazon Prime Video.

A cabin humidifier system and HEPA filtration are also featured, which optimize health and comfort, leaving passengers more relaxed and fresher upon reaching their destination.

The cabin configuration offers flexibility between lower density (36 pax) or higher density (46 pax) depending on the client's preference and mission profile, and the aircraft is also capable of being converted into Medevac configuration via the installation of up to three ICU modules.

For a restful and comfortable trip overnight or at any time of the flight, this aircraft offers a queen-sized bed, 4 lie-flat seats, and from 8 to 16 seats reclinable up to 140°.



DAY CONFIGURATION

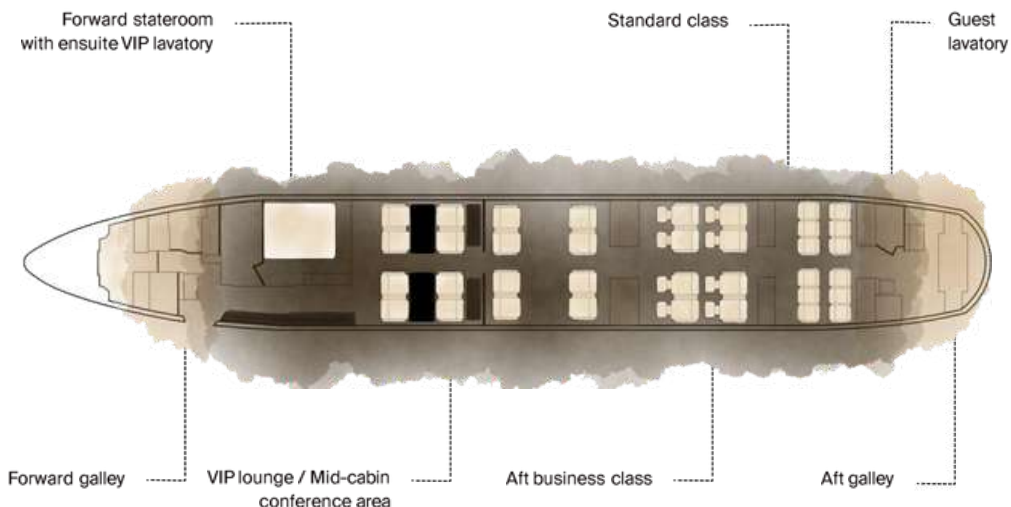

FLEET TYPE

REGISTRATION:	A6 DAS
AIRCRAFT:	Boeing Business Jet 737-700
YEAR OF MANUFACTURE:	2000
REFURBISHED:	2021

SPECIFICATIONS

CONFIGURATION A:	36 Seats, 1 Bedroom (front); 16 VIP, 8 Business, 12 Standard
RANGE:	9.5+ hours
LUGGAGE CAPACITY:	52-60 suitcases subject to weight and size
ENTERTAINMENT:	In-flight entertainment systems which allows passengers to stream high definition video content, High-quality sound system with overhead speakers and World Map subwoofers,
CONNECTIVITY:	Ka-Band WiFi, Cabin Satellite Phone, Fax
OTHER:	Cabin humidifier system, HEPA filtration

NIGHT CONFIGURATION

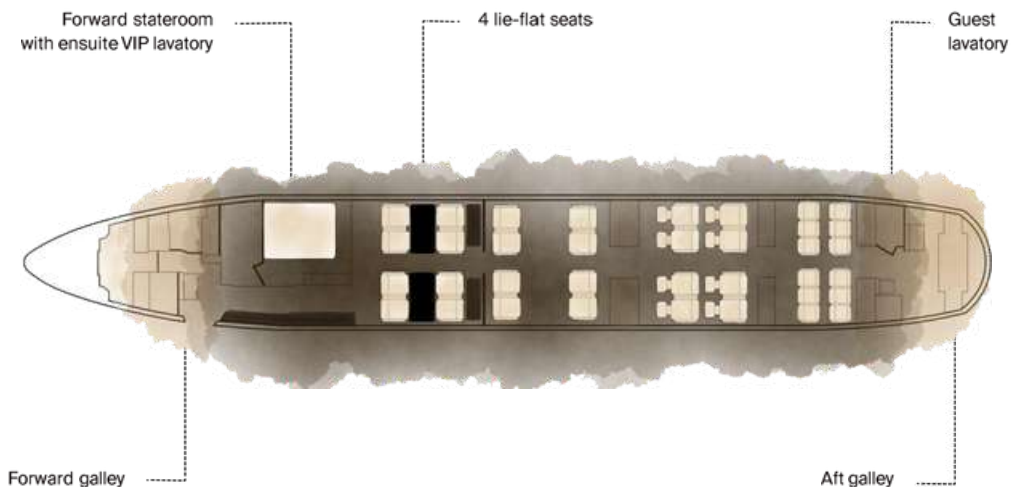

FLEET TYPE

<i>REGISTRATION:</i>	A6 DAS
<i>AIRCRAFT:</i>	Boeing Business Jet 737-700
<i>YEAR OF MANUFACTURE:</i>	2000
<i>REFURBISHED:</i>	2021

SPECIFICATIONS

<i>BEDROOM:</i>	1 Bedroom (front)
<i>SEAT TO BED:</i>	 8 seats to 4 beds via 4 lie-flat seats
<i>SEAT RECLINE:</i>	16 Business seats with 140° recline 12 Standard seats with 45° recline with no foot rest

DAY CONFIGURATION

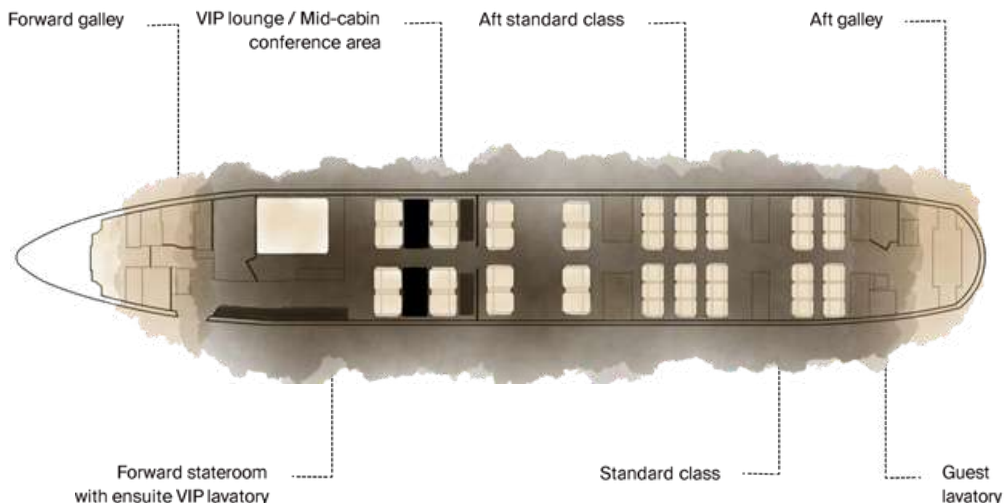

FLEET TYPE

REGISTRATION:	A6 DAS
AIRCRAFT:	Boeing Business Jet 737-700
YEAR OF MANUFACTURE:	2000
REFURBISHED:	2021

SPECIFICATIONS

CONFIGURATION B:	46 Seats, 1 Bedroom (front); 16 VIP, 30 Standard
RANGE:	9.5+ hours
LUGGAGE CAPACITY:	52-60 suitcases subject to weight and size
ENTERTAINMENT:	In-flight entertainment systems which allows passengers to stream high definition video content, High-quality sound system with overhead speakers and subwoofers, World Map
CONNECTIVITY:	Ka-Band WiFi, Cabin Satellite Phone, Fax
OTHER:	Cabin humidifier system, HEPA filtration

NIGHT CONFIGURATION

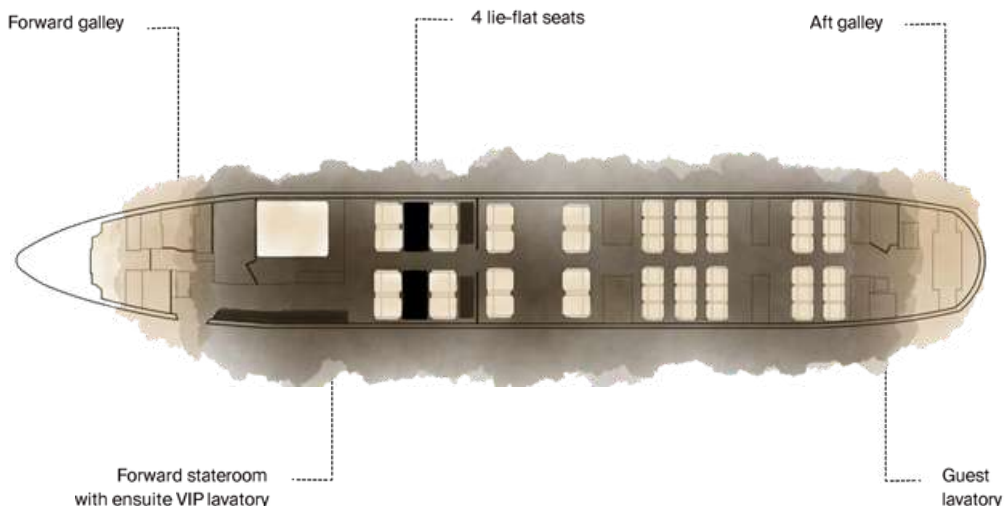

FLEET TYPE

<i>REGISTRATION:</i>	A6 DAS
<i>AIRCRAFT:</i>	Boeing Business Jet 737-700
<i>YEAR OF MANUFACTURE:</i>	2000
<i>REFURBISHED:</i>	2021

SPECIFICATIONS

<i>BEDROOM:</i>	1 Bedroom (front)
<i>SEAT TO BED:</i>	 8 seats to 4 beds via 4 lie-flat seats
<i>SEAT RECLINE:</i>	8 Business seats with 140° recline 30 Standard seats with 45° recline with no foot rest

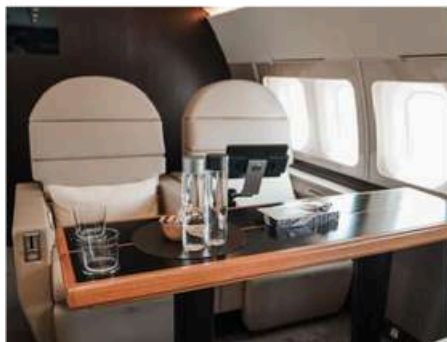

BOEING BUSINESS JET

A6 AIN

This beautiful recently upgraded aircraft offers a VVIP interior which includes a forward stateroom and ensuite VIP lavatory, forward and aft galleys, club/conference seating and a VIP lounge (majlis) mid-cabin, and aft business class and standard class seating.

A full interior refurbishment was done on this aircraft in 2014 using premium materials such as Ostrich skin and high gloss wood veneer. It also features a state-of-the-art iPad-controlled IFE System, a high-quality sound system which includes overhead speakers and subwoofers, and HEPA filtration which optimize passenger health and comfort.

In late 2020, further interior touch-ups were completed and communications were upgraded to the latest and highest speed system (Ka-Band WiFi) available globally. This system allows for streaming of high definition video content, including via passengers' own accounts with providers such as Apple TV, Netflix, and Amazon Prime Video.

The cabin configuration offers flexibility between lower density (36 pax), or higher density (46 pax) depending on the client's preference and mission profile, and the aircraft is also capable of being converted into Medevac configuration via the installation of up to three ICU modules.

For a restful and comfortable trip overnight or at any time of the flight, this aircraft offers a queen-sized bed, 4 lie-flat seats and up to 24 seats reclinable to 140°.



DAY CONFIGURATION

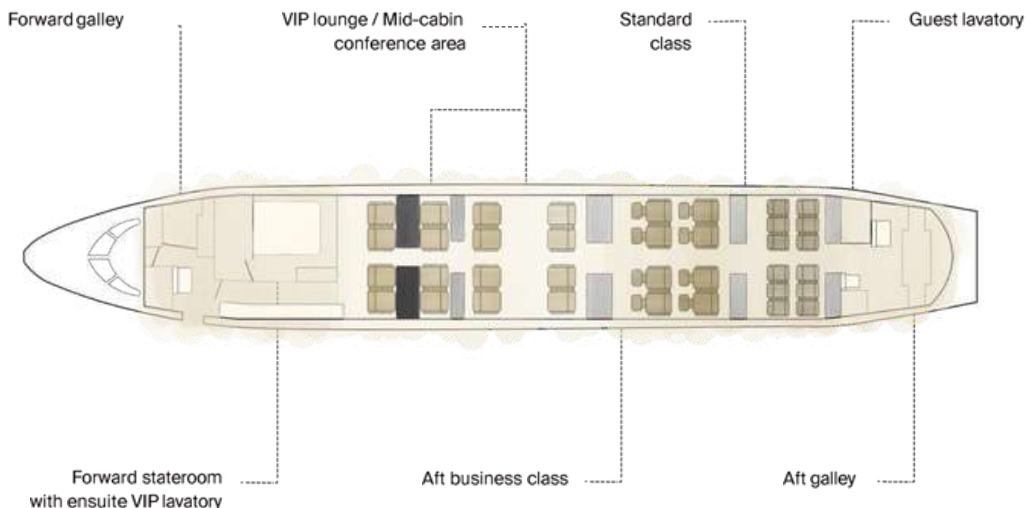

FLEET TYPE

REGISTRATION:	A6 AIN
AIRCRAFT:	Boeing Business Jet 737-700
YEAR OF MANUFACTURE:	1999
REFURBISHED:	2014

SPECIFICATIONS

CONFIGURATION A:	36 Seats, 1 Bedroom (front); 16 VIP, 8 Business, 12 Standard
RANGE:	9.5+ hours
LUGGAGE CAPACITY:	52-60 suitcases subject to weight and size
ENTERTAINMENT:	State-of-the-art iPad-controlled IFE System, High-quality sound system with overhead speakers and subwoofers
CONNECTIVITY:	Ka-Band WiFi, GSM Phone, Cabin Satellite Phone, Fax
OTHER:	HEPA filtration

NIGHT CONFIGURATION

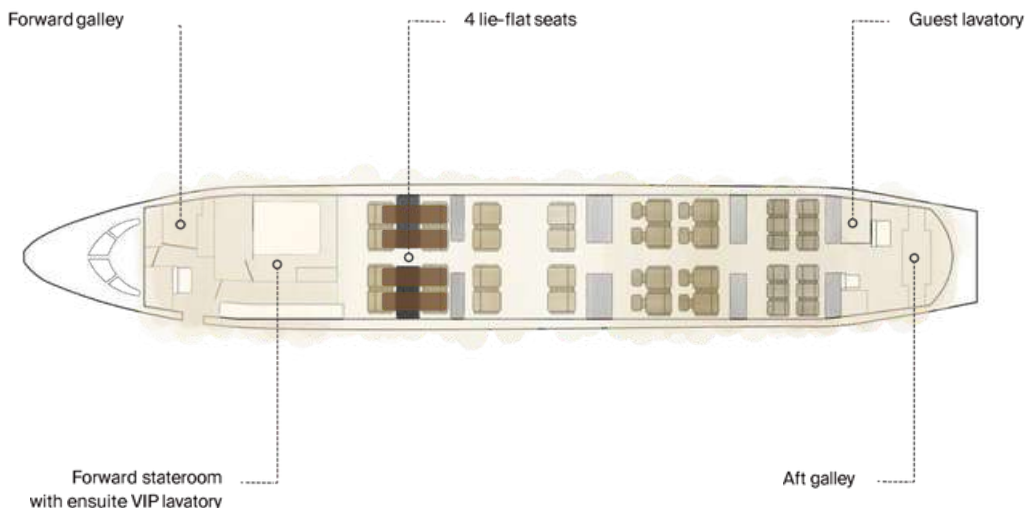

FLEET TYPE

REGISTRATION:	A6 AIN
AIRCRAFT:	Boeing Business Jet 737-700
YEAR OF MANUFACTURE:	1999
REFURBISHED:	2014

SPECIFICATIONS

BEDROOM:	1 Bedroom (front)
SEAT TO BED:	 8 seats to 4 beds via 4 lie-flat seats
SEAT RECLINE:	16 Business seats with 140° recline 12 Standard seats with 45° recline with no foot rest

DAY CONFIGURATION

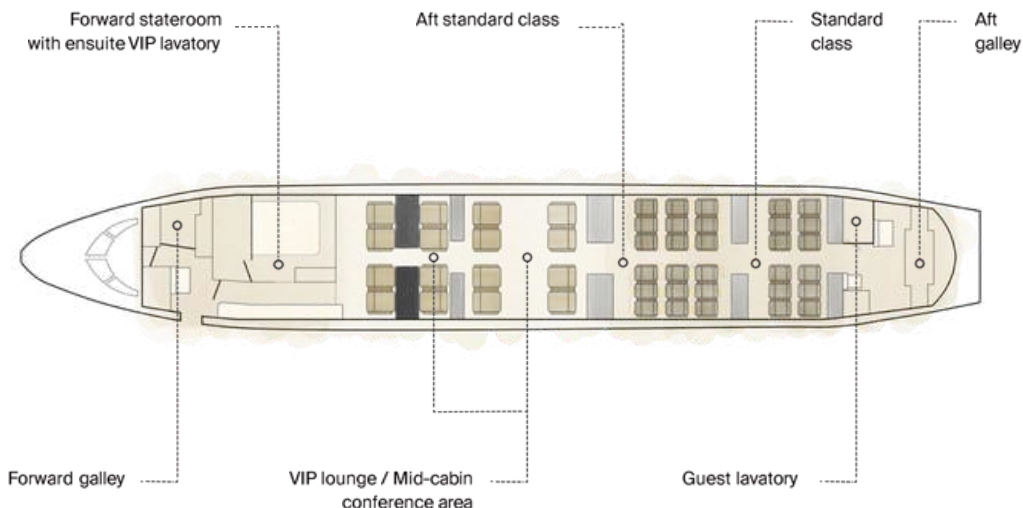

FLEET TYPE

REGISTRATION:	A6 AIN
AIRCRAFT:	Boeing Business Jet 737-700
YEAR OF MANUFACTURE:	1999
REFURBISHED:	2014

SPECIFICATIONS

CONFIGURATION B:	46 Seats, 1 Bedroom (front); 16 VIP, 30 Standard
RANGE:	9.5+ hours
LUGGAGE CAPACITY:	52-60 suitcases subject to weight and size
ENTERTAINMENT:	State-of-the-art iPad-controlled IFE System, High-quality sound system with overhead speakers and subwoofers
CONNECTIVITY:	Ka-Band WiFi, GSM Phone, Cabin Satellite Phone, Fax
OTHER:	HEPA filtration

NIGHT CONFIGURATION

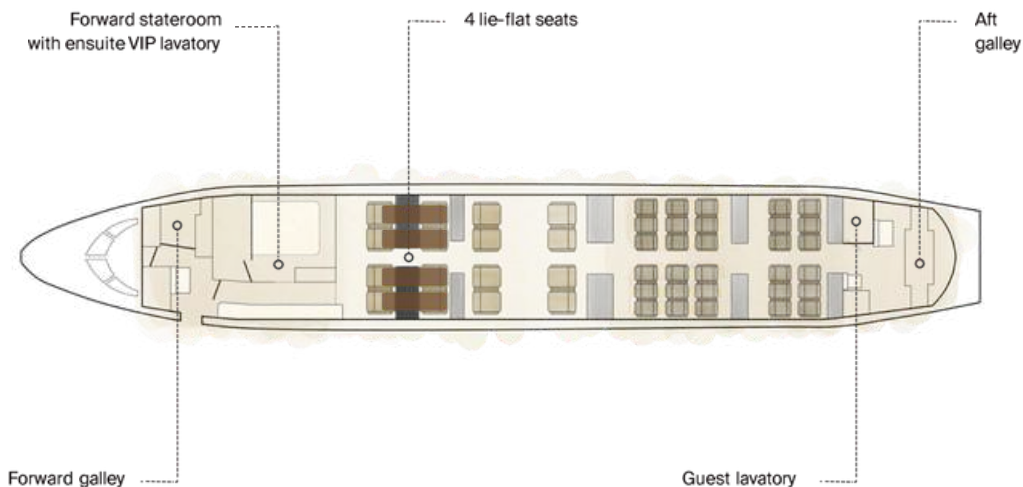

FLEET TYPE

REGISTRATION:	A6 AIN
AIRCRAFT:	Boeing Business Jet 737-700
YEAR OF MANUFACTURE:	1999
REFURBISHED:	2014

SPECIFICATIONS

BEDROOM:	1 Bedroom (front)
SEAT TO BED:	 8 seats to 4 beds via 4 lie-flat seats
SEAT RECLINE:	8 Business seats with 140° recline 30 Standard seats with 45° recline with no foot rest



BOEING BUSINESS JET

A6RJZ

This beautiful aircraft offers forward and mid cabin club/conference groupings, a forward VIP lavatory, forward and aft galleys, aft business class, and standard class seating.

The interior of this aircraft was created utilizing premium materials, including high end leathers and gloss wood veneers, and state-of-the-art systems. It features a broadcast IFE System and lighting controls via the cabin management system and is also equipped with a high-quality sound system including overhead speakers and subwoofers.

HEPA filtration is also featured, which optimizes health and comfort, leaving passengers more relaxed and fresh upon reaching their destination.

The cabin configuration offers flexibility between lower density (42 pax), or higher density (52 pax) depending on the client's preference and mission profile, and the aircraft is also capable of being converted into Medevac configuration via the installation of up to four ICU modules.

For a restful and comfortable trip overnight or at any time of the flight, this aircraft is equipped with up to 30 lie-flat or 140° reclining seats.



DAY CONFIGURATION

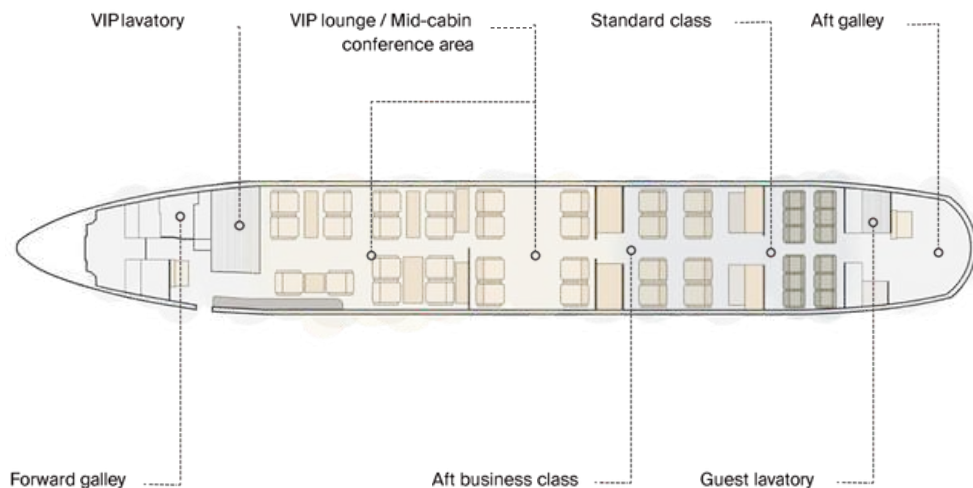

FLEET TYPE

REGISTRATION:	A6RJZ
AIRCRAFT:	Boeing Business Jet 737-700
YEAR OF MANUFACTURE:	1999

SPECIFICATIONS

CONFIGURATION A:	42 Seats; 22 VIP, 8 Business, 12 Standard
RANGE:	9.5+ hours
LUGGAGE CAPACITY:	52-60 suitcases subject to weight and size
ENTERTAINMENT:	Broadcast IFE System, High-quality sound system with overhead speakers and subwoofers, World Map
CONNECTIVITY:	Cabin Satellite Phone, Fax
OTHER:	HEPA filtration

NIGHT CONFIGURATION

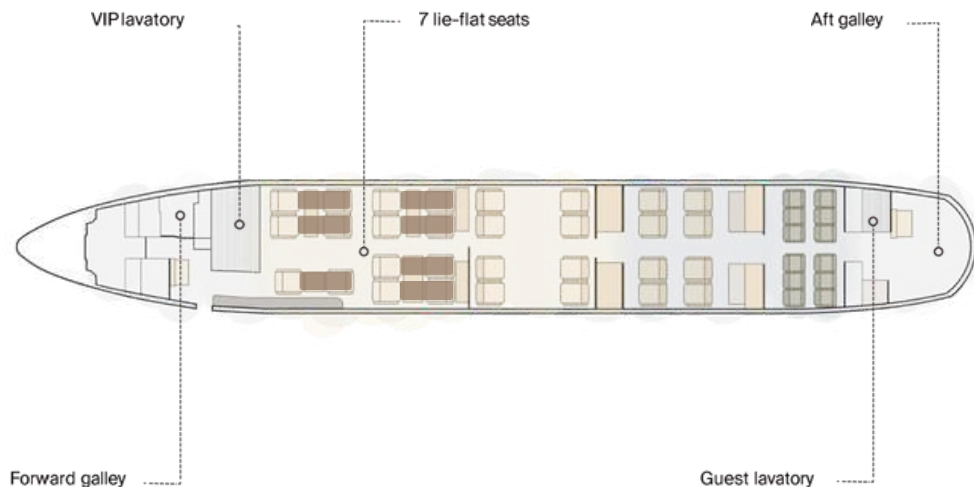

FLEET TYPE

REGISTRATION:	A6RJZ
AIRCRAFT:	Boeing Business Jet 737-700
YEAR OF MANUFACTURE:	1999

SPECIFICATIONS

SEAT TO BED:	 14 seats to 7 beds via 7 lie-flat seats
SEAT RECLINE:	16 Business seats with 140° recline 12 Standard seats with 45° recline with no foot rest

DAY CONFIGURATION

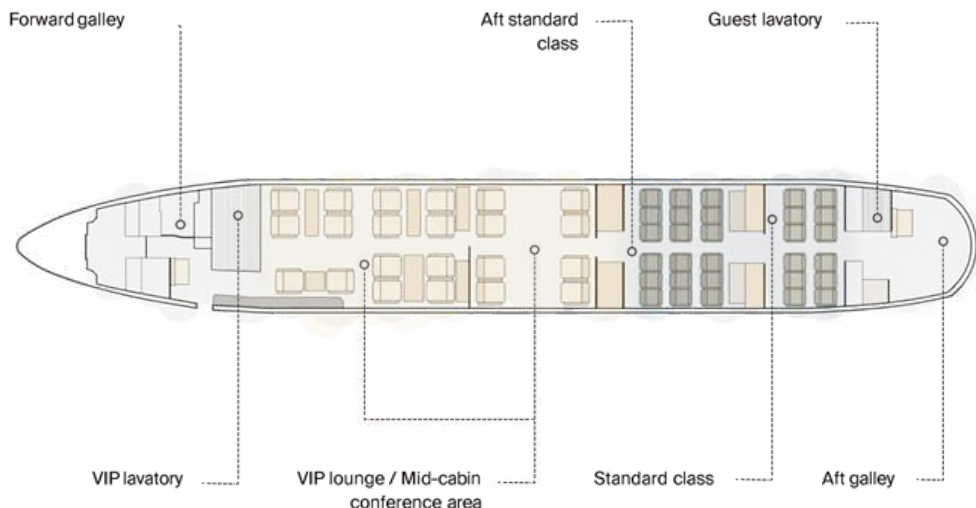

FLEET TYPE

REGISTRATION:	A6RJZ
AIRCRAFT:	Boeing Business Jet 737-700
YEAR OF MANUFACTURE:	1999

SPECIFICATIONS

CONFIGURATION B:	52 Seats; 22 VIP, 30 Standard
RANGE:	9.5+ hours
LUGGAGE CAPACITY:	52-60 suitcases subject to weight and size
ENTERTAINMENT:	Broadcast IFE System, High-quality sound system with overhead speakers and subwoofers, World Map
CONNECTIVITY:	Cabin Satellite Phone, Fax
OTHER:	HEPA filtration

NIGHT CONFIGURATION

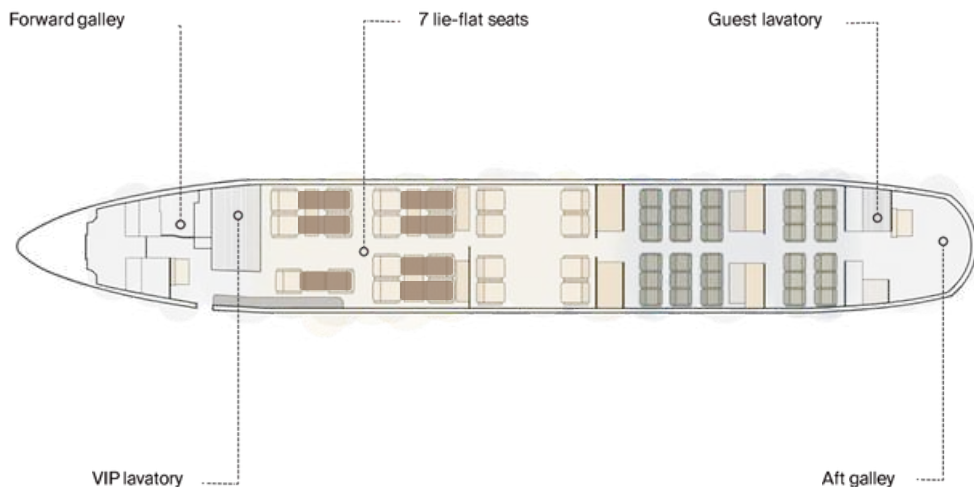

FLEET TYPE

REGISTRATION:	A6RJZ
AIRCRAFT:	Boeing Business Jet 737-700
YEAR OF MANUFACTURE:	1999

SPECIFICATIONS

SEAT TO BED:	 14 seats to 7 beds via 7 lie-flat seats
SEAT RECLINE:	8 Business seats with 140° recline 30 Standard seats with 45° recline with no foot rest

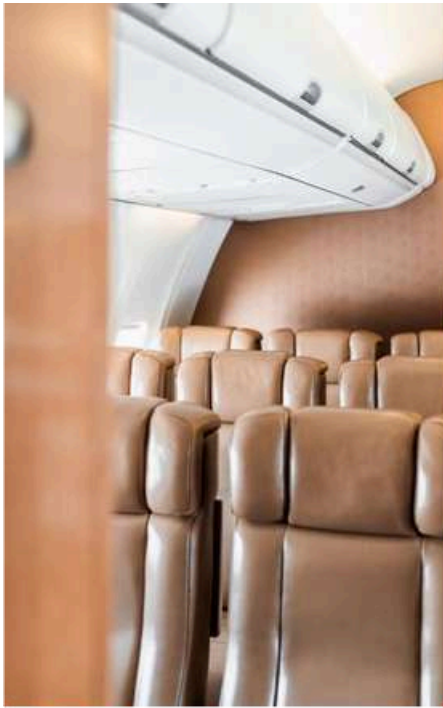

A6 RJK

The A6 RJK, a unique Boeing Business Jet (BBJ) offers unparalleled versatility and performance. This aircraft is equipped with a cargo door and a reconfigurable interior, making it ideal for a wide range of missions. The JK can be configured in four distinct ways: a spacious 92-seat economy cabin for large delegations, a luxurious 58-seat all-business class cabin for both business and leisure travel, an exclusive 34-seat VIP cabin for the most discerning travellers, and a purpose-built cargo configuration for transporting heavy equipment or high-value items.

The aircraft's state-of-the-art features include a cargo door, reconfigurable interior, KA-band connectivity for the fastest in-flight internet network, and FANS 1/A technology for seamless communication with air traffic control.

Additionally, the RJK is equipped with the first-ever Boeing BBJ certified flexible auxiliary tank configuration offered by Quiet Wings in Seattle, USA. This innovative feature allows for a wide range of aircraft ranges and cargo capacities, tailored to specific mission requirements.

The aircraft can be configured with 0 to 6 auxiliary tanks, and this configuration can be performed on the line within 24 hours.

The RJK is more than just an aircraft; it's a symbol of performance and versatility. Experience the future of private aviation with Royaljet.



34 SEAT CONFIGURATION

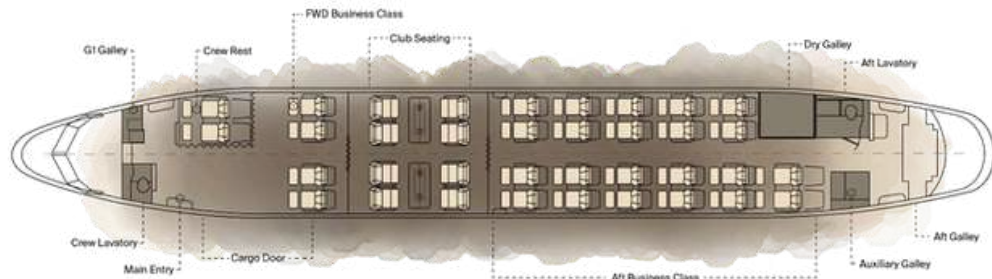

FLEET TYPE

REGISTRATION:	A6 RJK
AIRCRAFT:	Boeing 737-700C
ENTRY INTO SERVICE:	2024

SPECIFICATIONS

CONFIGURATION:	34 seats
OTHERS	Flexible fuel tank system to suit various needs Thinkom technology KA antenna

58 SEAT CONFIGURATION

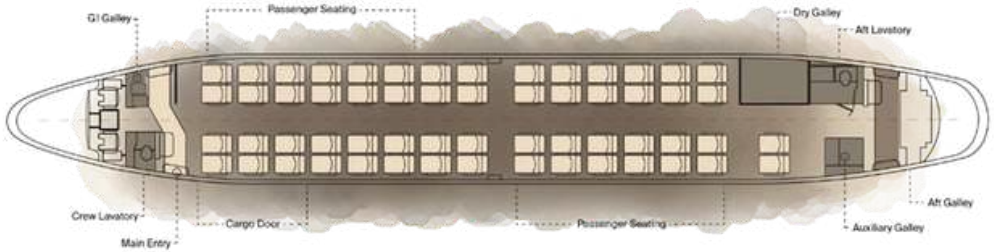

Step into a modern aircraft with a streamlined single-aisle cabin, with a width of 11.5 feet, ceiling height of 71 inches, and 20.5-inch aisle, to balance efficiency and comfort. Seats feature a 28.5° recline, precise dimensions, and ergonomic alignment for optimal passenger support, while structural elements ensure stability. Thoughtful legroom, footrest, and seat pitch design enhance onboard flow, maximizing space use without compromising comfort. Every aspect of the cabin and seating is engineered to deliver a safe, practical, and enjoyable flying experience.

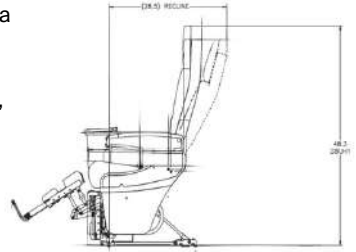

FLEET TYPE

REGISTRATION:	A6 RJK 737-700C
AIRCRAFT:	Boeing
ENTRY INTO SERVICE:	2024

SPECIFICATIONS

CONFIGURATION: 58 seats

OTHERS Flexible fuel tank system to suit various needs
Thinkom technology KA antenna

92 SEAT CONFIGURATION

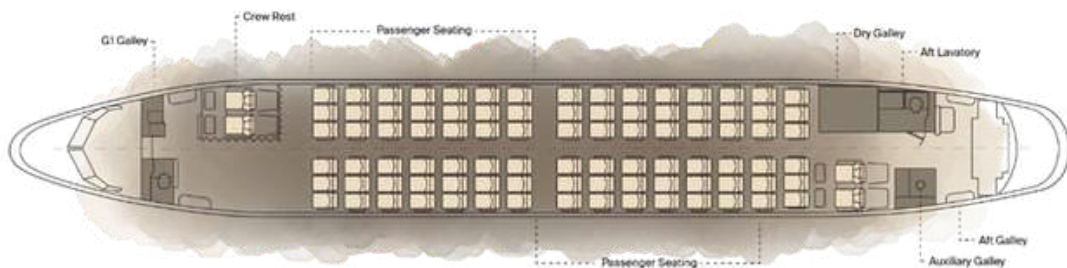

FLEET TYPE

REGISTRATION:	A6RJK
AIRCRAFT:	Boeing 737-700C
ENTRY INTO SERVICE:	2024

SPECIFICATIONS

CONFIGURATION:	92 seats
OTHERS	Flexible fuel tank system to suit various needs Thinkom technology KA antenna

CARGO CONFIGURATION

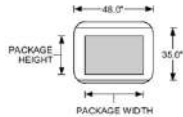

Cargo Hold Door FWD

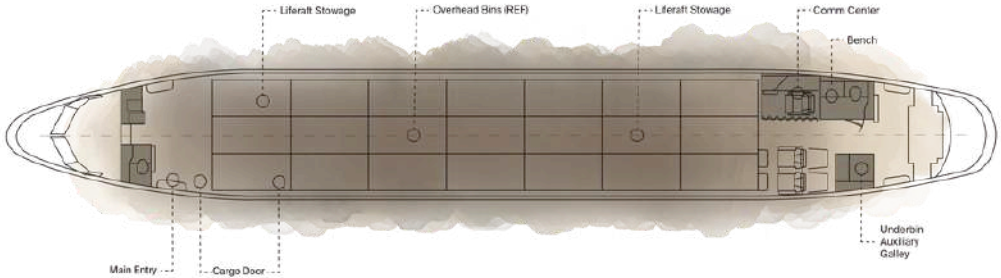

Main Deck Cargo Door

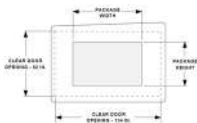

Cargo Hold Door AFT

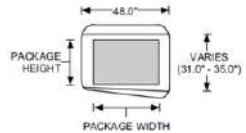

FLEET TYPE

REGISTRATION: A6 RJK
 AIRCRAFT: Boeing 737-700C
 ENTRY INTO SERVICE: 2024

SPECIFICATIONS

CONFIGURATION: Cargo
 OTHER: Max. Structural Payload: 15549 Kg
 Max. Main Deck Net Capacity: 14639 Kg (separately, on 7 Pallets)
 Max. Lower Cargo Hold Net Capacity: 4680 Kg (separately in Holds)
 Max. Combined Net Capacity = 14639 Kg (due Max. Structural Payload)

Note: In this case the combined capacity is not the addition of main deck and cargo hold; because it's limited due to max. Structural Payload = MZFW - Basic Operating weight (Including crew combination + Payload + Ops Items)

A6 RJK - Cargo

MAIN DECK CARGO COMPARTMENT VOLUME

CARGO COMPARTMENT	LOCATION - B.A		TOTAL VOLUME CU FT	B.A IN.
	FROM	TO		
Main Deck	293.0	1004.0	2784	648.5

MAIN DECK CARGO COMPATIBLE PALLETS

ULD	DIMENSIONS (IN.)	VOLUME (CU. FT)	TARE WEIGHT	MAX. GROSS WEIGHT	APPLICABILITY
Pallet	88 (L) x 108 (W) X 49 (H)	269	129 KG	4,536 KG	737-700C

MAIN DECK 9G CARGO BARRIER NET





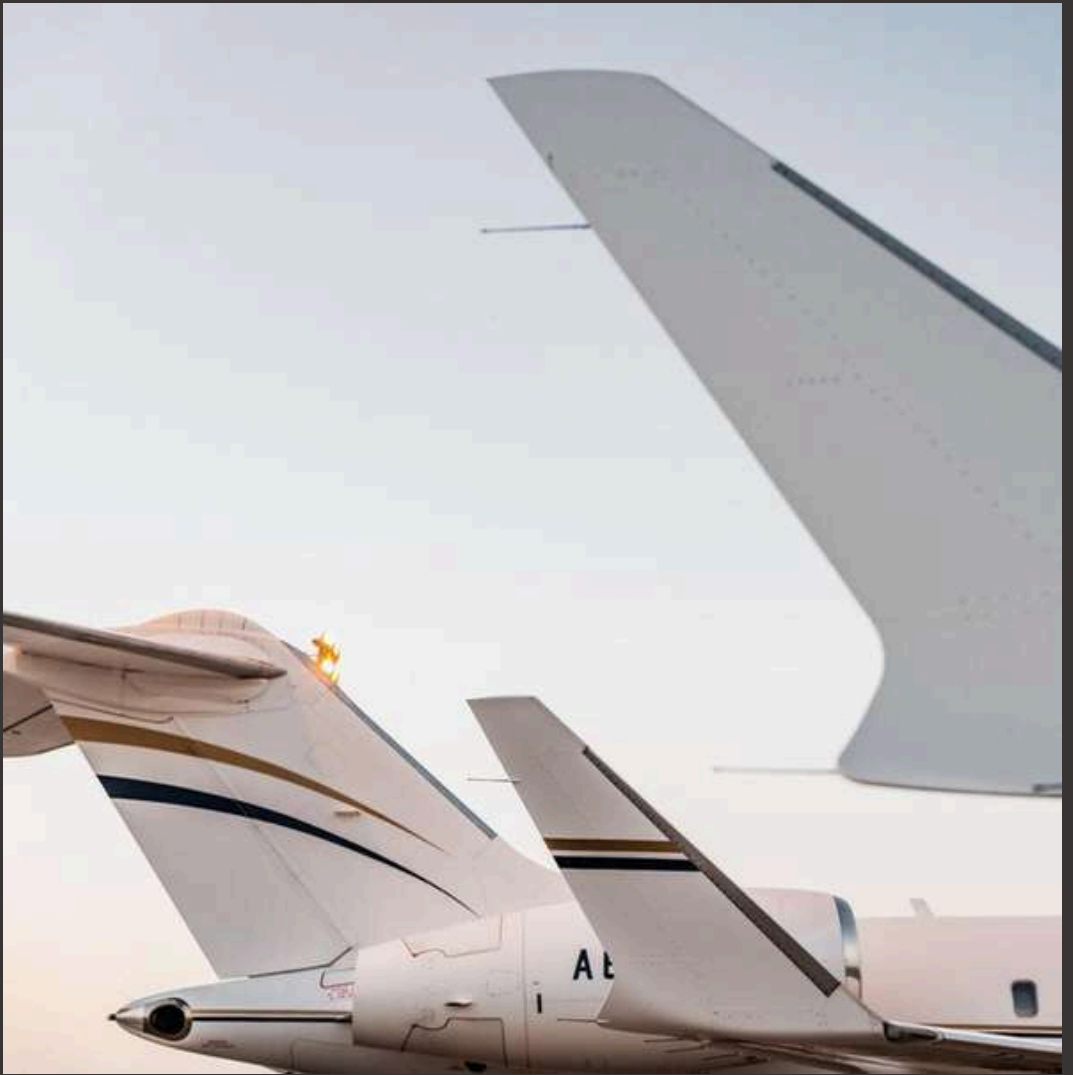

Bombardier Global

BOMBARDIER GLOBAL

A6RJC

These beautiful aircraft are two of the youngest in our fleet, having joined us fresh from the factory in 2015. Their interiors are classically designed, with a forward galley, a forward club four grouping, a mid-cabin conference arrangement and an aft VVIP lounge (majlis) with a VIP lavatory.

The interiors of these aircraft were developed utilizing premium materials such as high end leathers and beautiful wood veneers. They also incorporate state-of-the-art systems, including Swift Broadband WiFi, an iPad-controlled IFE System, mood lighting, and a high-quality sound system with overhead speakers and subwoofers.

These aircraft feature some of the lowest cabin altitudes in the industry, along with HEPA filters, which optimize health and comfort, leaving passengers more relaxed and fresh upon reaching their destination.

The cabin configuration offers 13 passenger seats, via the forward club four, mid cabin conference four and the aft 3 place divan across from the club two.

For overnight or for rest at any time of the flight, this aircraft offers a single sleeper divan, 4 VIP seats which recline up to 140°, and 6 seats with 110° recline.



DAY CONFIGURATION

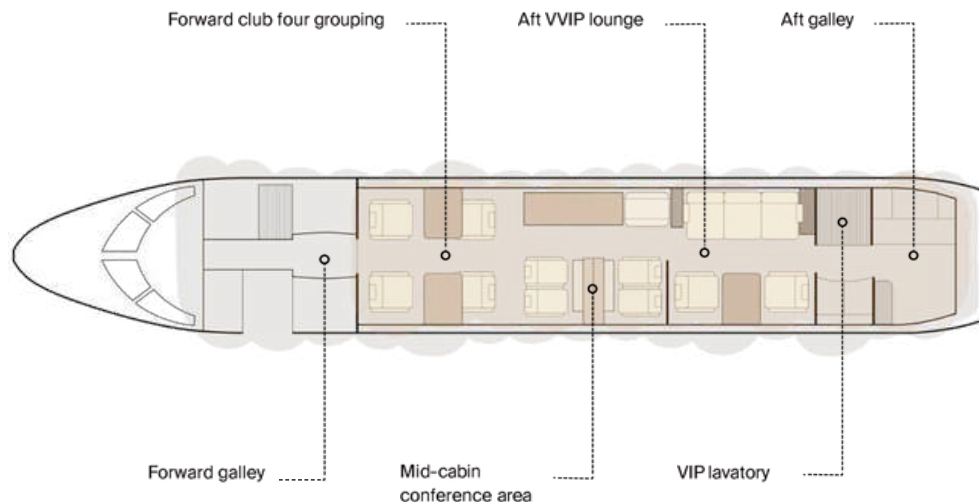

FLEET TYPE

REGISTRATION:	A6RJC
AIRCRAFT:	Bombardier Global 5000 Vision
YEAR OF MANUFACTURE:	2014
ENTRY INTO SERVICE:	2015

SPECIFICATIONS

CONFIGURATION B:	12 Seats, 10 VIP Seats, 2 on divan
RANGE:	11+ hours
LUGGAGE CAPACITY:	9-12 standard cases subject to weight and size
ENTERTAINMENT:	iPad-controlled IFE System, High-quality sound system with overhead speakers and subwoofers
CONNECTIVITY:	Swift Broadband WiFi, Cabin Satellite Phone, Fax
OTHER:	Low cabin altitude modification, HEPA filtration

NIGHT CONFIGURATION

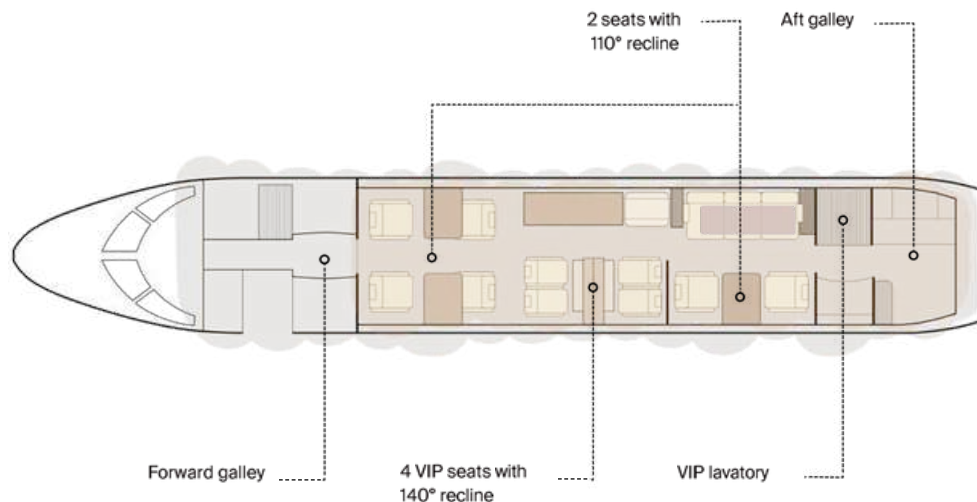

FLEET TYPE

REGISTRATION:	A6RJC
AIRCRAFT:	Bombardier Global 5000 Vision
YEAR OF MANUFACTURE:	2014
ENTRY INTO SERVICE:	2015

SPECIFICATIONS

SEAT TO BED:	 Single sleeper divan
SEAT RECLINE:	4 VIP seats with 140° recline 6 seats with 110° recline



BOMBARDIER GLOBAL

A6 RJD

These beautiful aircraft are two of the youngest in our fleet, having joined us fresh from the factory in 2015. Their interiors are classically designed, with a forward galley, a forward club four grouping, a mid-cabin conference arrangement and an aft VVIP lounge (majlis) with a VIP lavatory.

The interiors of these aircraft were developed utilizing premium materials such as high end leathers and beautiful wood veneers. They also incorporate state of the art systems, including Swift Broadband WiFi, an iPad-controlled IFE System, mood lighting, and a high-quality sound system with overhead speakers and subwoofers.

These aircraft feature some of the lowest cabin altitudes in the industry, along with HEPA filters, which optimize health and comfort, leaving passengers more relaxed and fresh upon reaching their destination.

The cabin configuration offers 13 passenger seats, via the forward club four, mid cabin conference four and the aft 3 place divan across from the club two.

For overnight or for rest at any time of the flight, this aircraft offers a single sleeper divan, 4 VIP seats which recline up to 140°, and 6 seats with 110° recline.



DAY CONFIGURATION

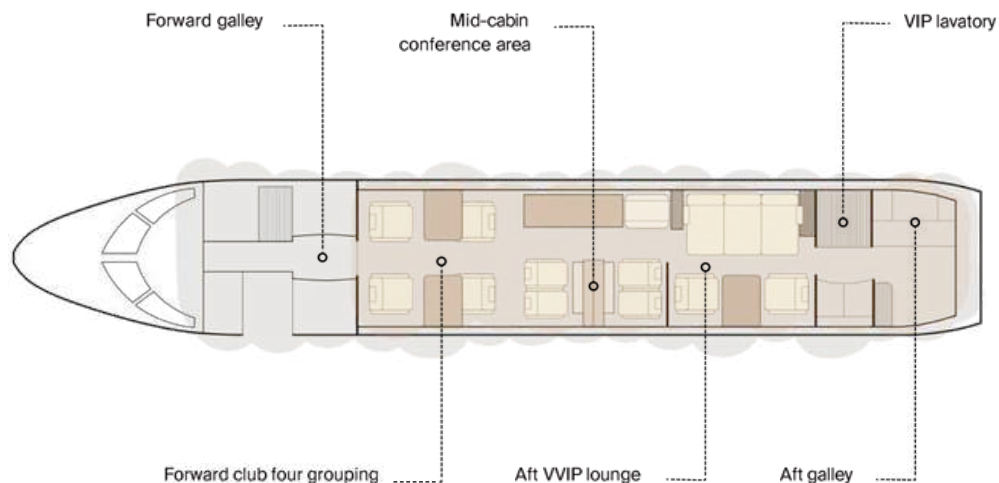

FLEET TYPE

REGISTRATION:	A6RJD
AIRCRAFT:	Bombardier Global 5000 Vision
YEAR OF MANUFACTURE:	2014
ENTRY INTO SERVICE:	2014

SPECIFICATIONS

CONFIGURATION:	12 Seats, 10 VIP Seats, 2 on divan
RANGE:	11+ hours
LUGGAGE CAPACITY:	9-12 standard cases subject to weight and size
ENTERTAINMENT:	iPad-controlled IFE System, High-quality sound system with overhead speakers and subwoofers
CONNECTIVITY:	Swift Broadband WiFi, Cabin Satellite Phone, Fax
OTHER:	Low cabin altitude modification, HEPA filtration

NIGHT CONFIGURATION

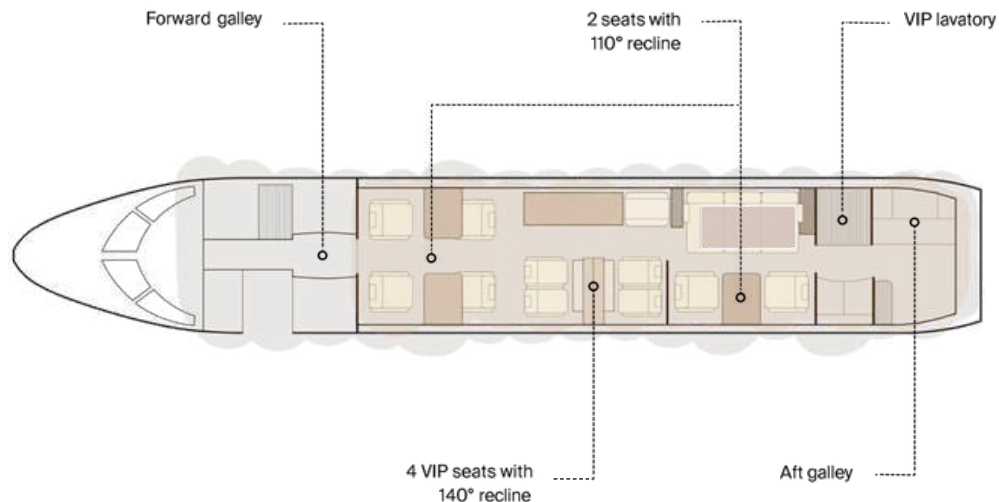

FLEET TYPE

<i>REGISTRATION:</i>	A6RJD
<i>AIRCRAFT:</i>	Bombardier Global 5000 Vision
<i>YEAR OF MANUFACTURE:</i>	2014
<i>ENTRY INTO SERVICE:</i>	2014

SPECIFICATIONS

<i>SEAT TO BED:</i>	 Single sleeper divan
<i>SEAT RECLINE:</i>	4 VIP seats with 140° recline 6 seats with 110° recline



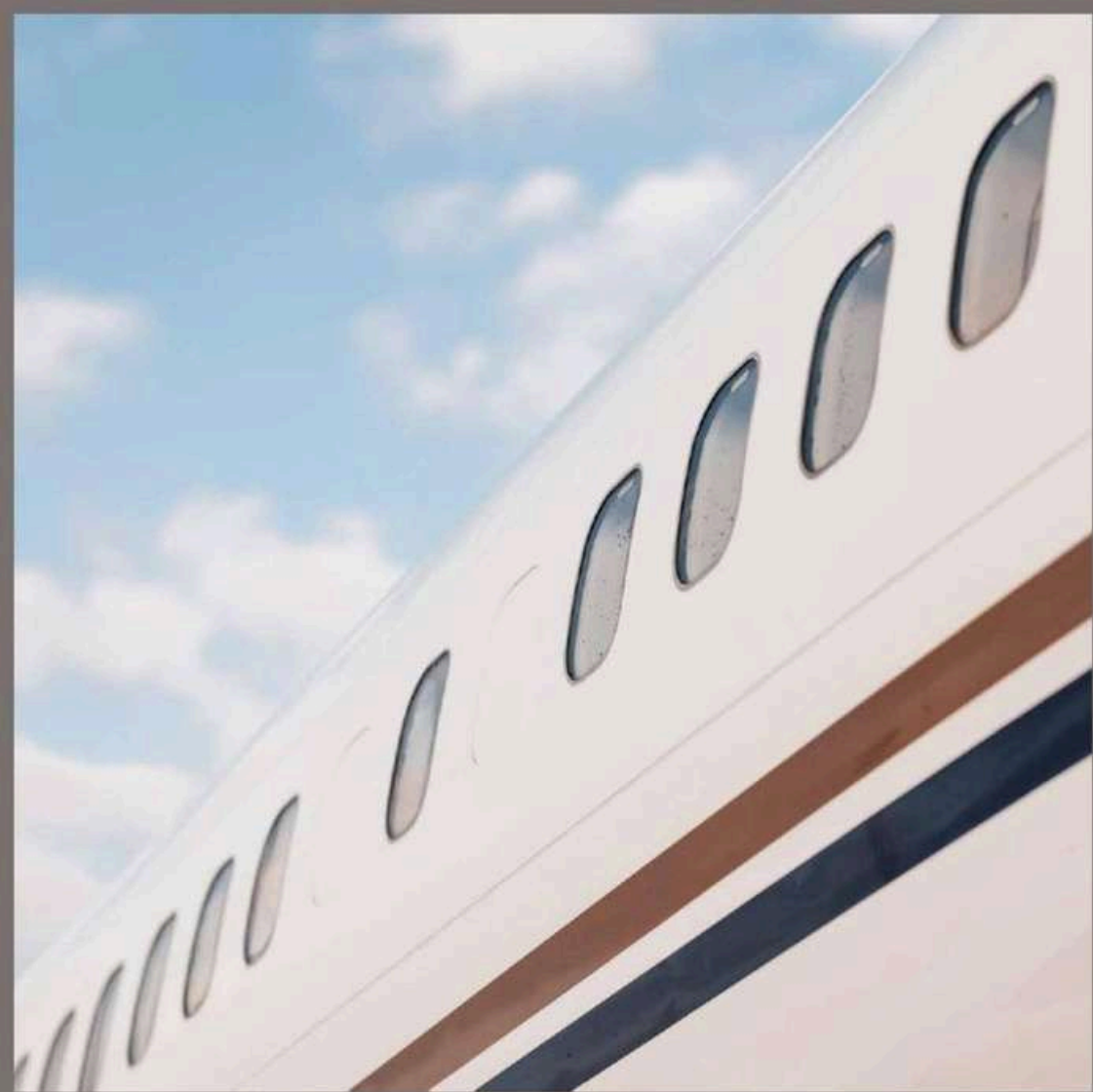

Medical Evacuation

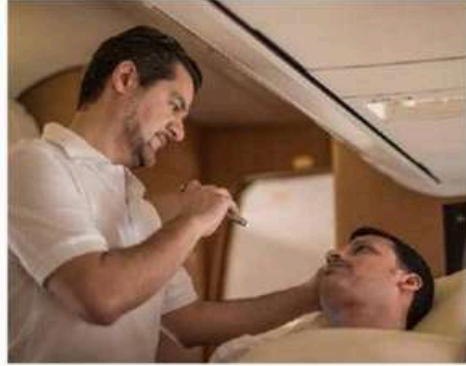
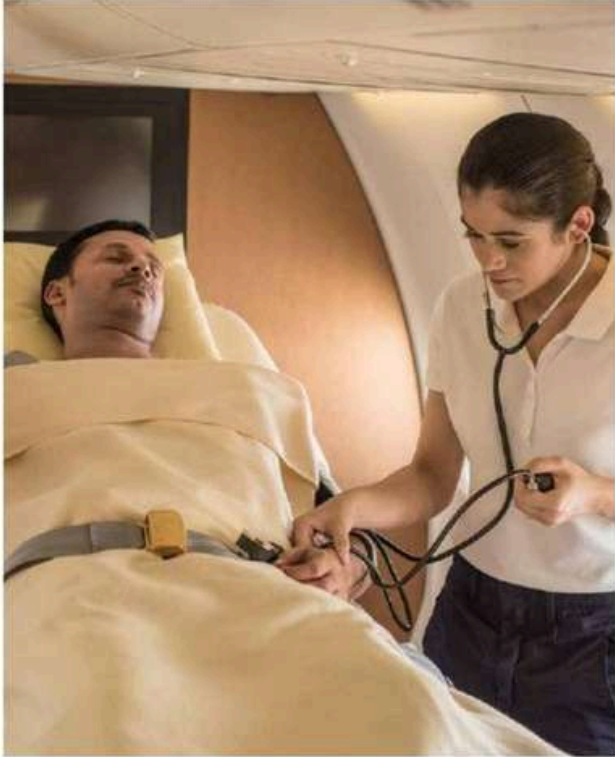

The pioneer of aeromedical evacuation in the Middle East

Alongside our success in premium private aviation, RoyalJet has also become the leading aeromedical evacuation service in the Middle East.

Whether you're arranging support for an individual patient, or an urgent mass evacuation, we can dispatch a fully equipped aircraft within two to three hours of your call, staffed by a highly trained medical team. Our doctors and nurses specialize in critical and emergency care, including neonatal, pediatric and cardiac treatment.

Each aircraft is equipped with the most advanced medical technology, including neonatal ventilators and defibrillators and a wide range of mobile critical care equipment.

MEDEVAC CONFIGURATION

One (1) Bed Layout

CONFIG CONTROL NO.: MED1-BBJ-A

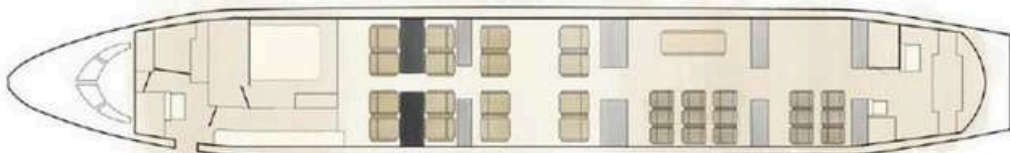

CONFIG CONTROL NO.: MED1-BBJ-B

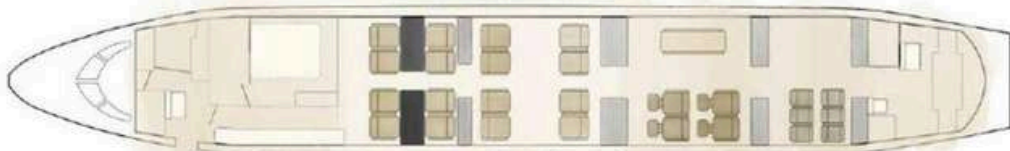

CONFIG CONTROL NO.: MED1-BBJ-C

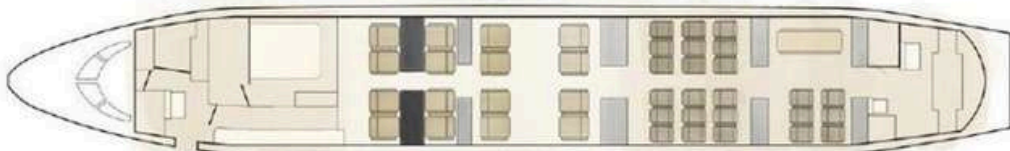

CONFIG CONTROL NO.: MED1-BBJ-D

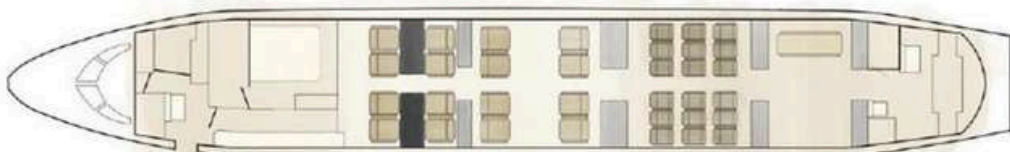

SPECIFICATIONS

EFFECTIVITY: A6 AIN, A6 DAS, A6 RJZ

MEDEVAC CONFIGURATION

Two (2) Bed Layout

CONFIG CONTROL NO.: MED2-BBJ-A

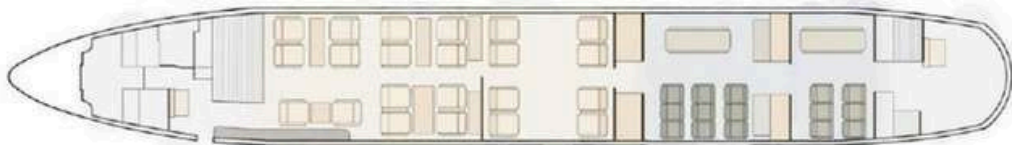

CONFIG CONTROL NO.: MED2-BBJ-B

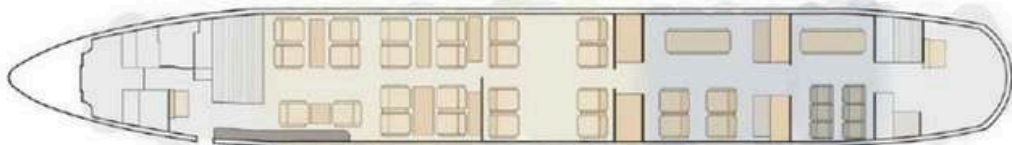

CONFIG CONTROL NO.: MED2-BBJ-C

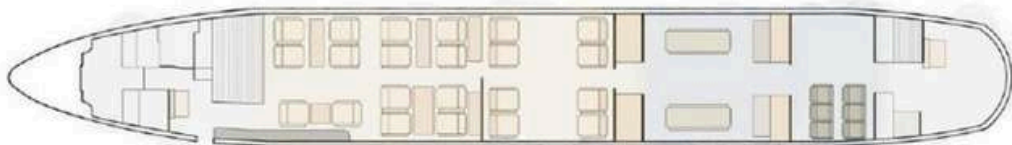

CONFIG CONTROL NO.: MED2-BBJ-D

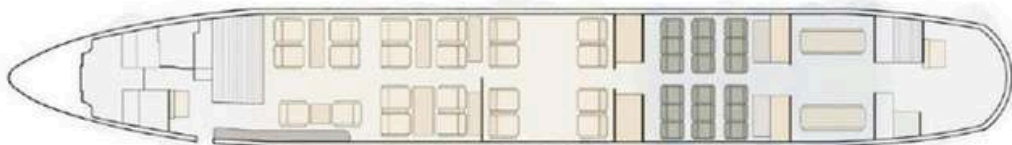

SPECIFICATIONS

EFFECTIVITY: A6 AIN, A6 DAS, A6 RJZ



**We look forward to
welcoming you
on board soon.**

ROYALJET HEADQUARTERS

Airport Area, Next to Presidential Flight
Abu Dhabi, United Arab Emirates

info@royaljetgroup.com | +971 2 505 1520

24 HOURS SALES

sales@royaljetgroup.com | +9712 5051500

ROYALJETGROUP.COM
