

Our Fleet Guide

Step inside a world of comfort and delight.

RoyalJet



Contents

03	<i>A MESSAGE FROM OUR CEO</i>
04	<i>ABOUT ROYALJET</i>
06	<i>OUR FLEET</i>
07	<i>OUR FBO</i>
08	<i>BOEING BUSINESS JETS</i>
09	A6 RJA
13	A6 RJU
17	A6 RJV
21	A6 DAS
27	A6 AIN
33	A6 RJX
37	A6 RJY
41	A6 RJZ
47	A6 DFR
51	<i>BOMBARDIER GLOBAL</i>
52	A6 RJC
56	A6 RJD
60	<i>MEDICAL EVACUATION</i>
61	<i>THE PIONEER OF AEROMEDICAL EVACUATION IN THE MIDDLE EAST</i>
62	MEDEVAC CONFIGURATIONS

A Message from our CEO

Welcome to the new RoyalJet experience. Our mission is to deliver personalized delight to each and every one of our guests, throughout their whole journey. We are not just here to transfer you from place to place; we are committed to exceeding our guests' expectations by tailoring every step of the way to make your experience meet their wants and needs.

RoyalJet owns and operates a state-of-the-art fleet composed of eleven Boeing Business Jets and three Bombardier Global 5000/6000 aircraft. A range of aviation-related services is also available to meet any requirements needed for all journeys.

RoyalJet is an award-winning premier private aviation company in the process of becoming the global reference in the industry while projecting the values and identity of Abu Dhabi and the UAE.

We look forward to welcoming you on board,

Mohammed Husain Ahmed
CEO, RoyalJet



About RoyalJet

The RoyalJet LLC is an Abu Dhabi owned and operated premium private aviation group of companies chaired by His Highness Sheikh Mohammed Bin Hamad Bin Tahnoon Al Nahyan.

With its headquarters in Abu Dhabi in the United Arab Emirates, RoyalJet operates from its Fixed Based Operations (FBO) / VIP Terminal at Abu Dhabi International Airport and the company and its employees hold multiple certifications and licenses issued by the UAE General Civil Aviation Authority and the Bermuda, Guernsey and San Marino Aviation Authorities.

The Group, through its Abu Dhabi and Bermuda entities, owns and/or operates eleven Boeing Business Jets and three Bombardier Global 5000/6000 aircraft, offering aircraft management, aircraft charter, aircraft leasing, medical evacuation flights, aircraft brokerage, flight support services, FBO services, aircraft maintenance, repair and CAMO services, aircraft acquisition and disposal services and VIP aviation consulting.





The RoyalJet LLC is a founding member of the Middle East Business Aviation Association (MEBAA), a member of various other industry associations, and its flight and ground operations are certified by the International Business Aviation Council (IBAC) and under the Wyvern Wingman program. Its FBO is also a member of the industry leading Air Elite Network.

RoyalJet is also a proud multiple winner of the "World's Leading Private Jet Charter" category at the annual World Travel Awards and its FBO has won multiple awards for its facilities and services.



Our Fleet

The RoyalJet award winning charter fleet features flexibility and choice unparalleled in premium private aviation. We operate by far the largest fleet in the world of Boeing Business Jets – the leading VIP airliner on the market – and with ten spectacular aircraft of this type available for charter, we can deliver various configurations to suit your needs. We also operate three beautiful Bombardier Global 5000/6000 aircraft – the leading private jet in its class – for your smaller groups and specific missions.



Our FBO

An FBO experience for people – and from people – we believe that whether you're traveling private, business class, or first class, you deserve to have a luxurious experience from start to finish.





Boeing Business Jets

BOEING BUSINESS JET

A6 RJA

RoyalJet's latest acquisition – a Boeing Business Jet – was acquired by the company in early 2022 and is now ready for charter after undergoing upgrades and technology enhancements in Basel, Switzerland over the past few months.

This BBJ boasts 19 passenger VVIP interior with a forward crew rest area, master bedroom with private lavatory and shower, and a mid-cabin open-plan lounge. It has been finished with custom-made materials and state-of-the-art design configuration for best functionality and maximum comfort. The cabin can also sleep up to 12 in VVIP lie-flat seats and its queen-sized bed.

The aircraft was upgraded with special soundproofing to reduce in-flight noise levels, along with a low cabin altitude modification, special humidifiers, and a HEPA filtration system. All designed to optimize the health and comfort of our VIPs, meaning passengers will be more relaxed and fresher upon reaching their destination.

To further enhance the on board experience this aircraft is fitted with the latest technology and the best connectivity available in the market. This includes the very latest lighting, cabin management, and in-flight entertainment systems, complemented by a high-quality sound system including overhead speakers and subwoofers.

This aircraft is the longest-range BBJ in RoyalJet fleet, with auxiliary fuel tanks giving it the capability to fly non-stop for more than 12 hours and reach almost any destination globally with only one short fuel stop.



DAY CONFIGURATION

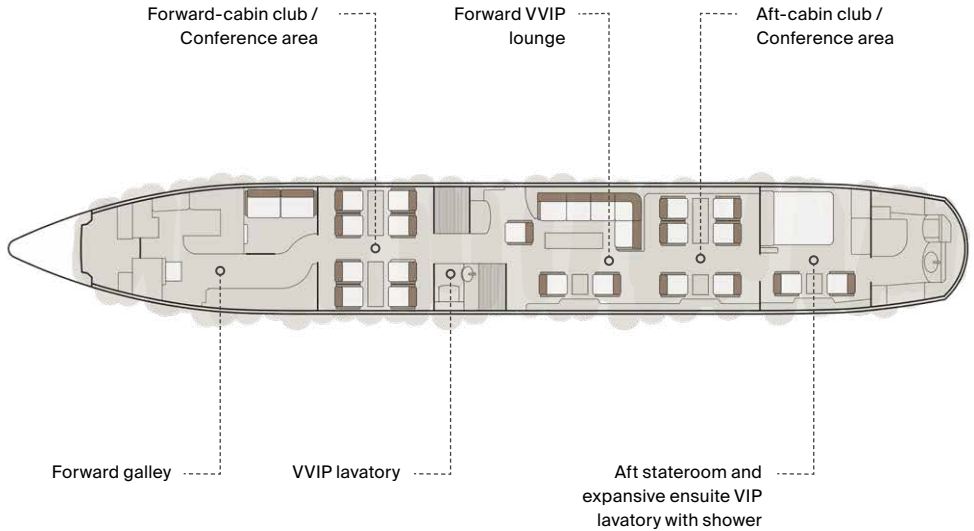

FLEET TYPE

<i>REGISTRATION:</i>	A6 RJA
<i>AIRCRAFT:</i>	Boeing BBJ-1
<i>ENTRY INTO SERVICE:</i>	2011

SPECIFICATIONS

<i>CONFIGURATION:</i>	19 Seats, , 1 Bedroom (rear); 17 VIP, 2 on divan
<i>RANGE:</i>	12+ hours
<i>LUGGAGE CAPACITY:</i>	23-30 suitcases subject to weight and size
<i>ENTERTAINMENT:</i>	Airshow 410, Dual 21.3-inch monitors, three 37-inch monitors, State-of-the-art iPad-controlled IFE System
<i>CONNECTIVITY:</i>	Ka-Band WiFi, Cabin Satellite Phone
<i>OTHER:</i>	Low cabin altitude modification, Manual Full Room Humidifiers

NIGHT CONFIGURATION

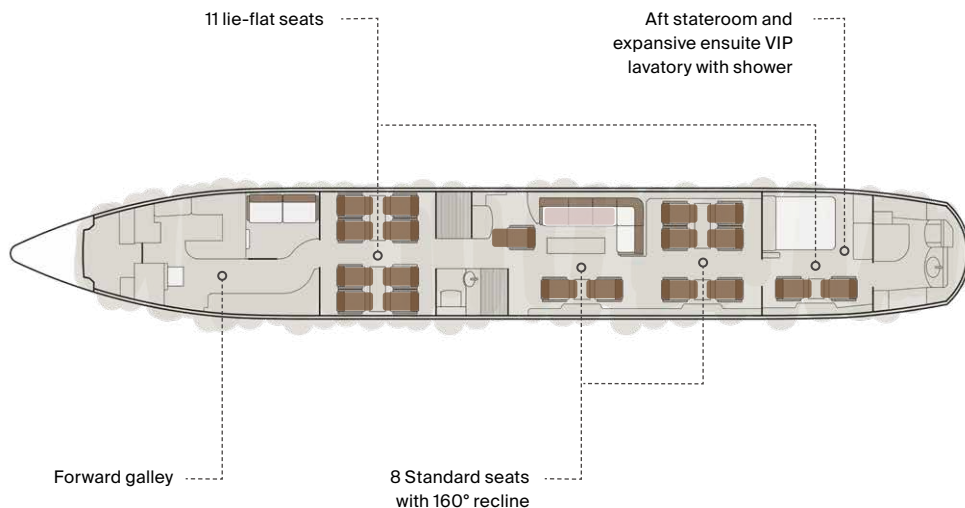

FLEET TYPE

<i>REGISTRATION:</i>	A6 RJA
<i>AIRCRAFT:</i>	Boeing BBJ-1
<i>ENTRY INTO SERVICE:</i>	2011

SPECIFICATIONS

<i>BEDROOM:</i>	1 Bedroom (back)
<i>SEAT TO BED:</i>	 11 lie-flat seats
	 1 single sleeper divan
<i>SEAT RECLINE:</i>	8 Standard seats with 160° recline



BOEING BUSINESS JET

A6 RJU

This aircraft is one of the newest in our fleet, having joined us fresh from the factory in 2017, and offers a forward stateroom with ensuite VIP lavatory, forward and aft galleys, a mid-cabin club / conference area, aft business class, and standard class seating.

The contemporary design of this aircraft features carbon fiber and premium materials throughout the cabin, along with a unique cool mood lighting system with over a million color variations, which is controlled by the customer operated iPad-based cabin management system.

This aircraft also boasts a state-of-the-art video-on-demand IFE System, enhanced by our high-quality sound system with overhead speakers and subwoofers, which can be controlled by the RoyalJet provided iPads or via the customer's own device. To maximize the value of this system for our guests, the aircraft has also been equipped with the highest speed communications system (Ka-Band WiFi) available globally. This system allows passengers to stream high definition video content throughout the flight, including via their own personal account with providers such as Apple TV, Netflix, and Amazon Prime Video.

A low cabin altitude modification and HEPA filtration are also featured, which optimize health and comfort, leaving passengers more relaxed and fresher upon reaching their destination.

The cabin configuration offers 34 seats via the mid cabin club eight arrangement, the eight mid/aft business class seats and the 18 aft standard class seats. For overnight or at any time of the flight, this aircraft features a queen-sized bed and 16 lie-flat seats.



DAY CONFIGURATION

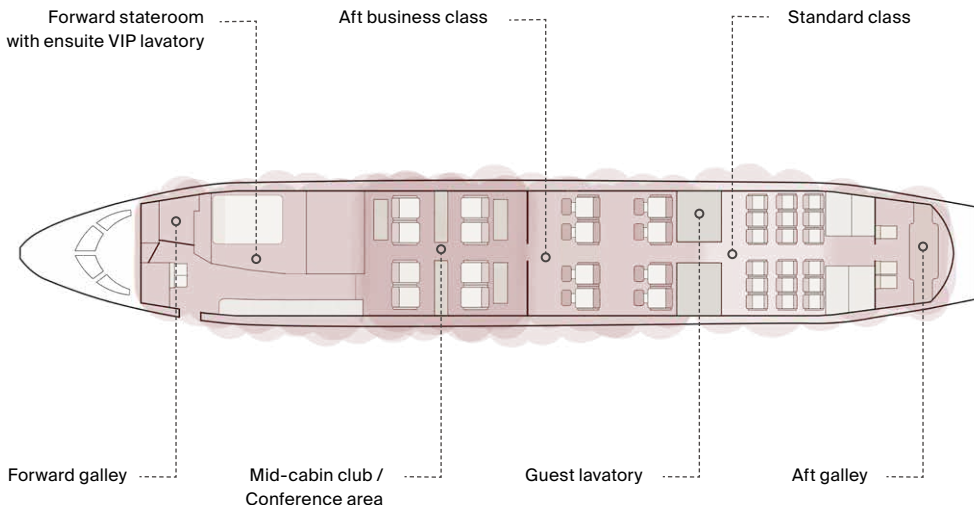

FLEET TYPE

REGISTRATION:	A6 RJU
AIRCRAFT:	Boeing Business Jet B737-77W
YEAR OF MANUFACTURE:	2015
ENTRY INTO SERVICE:	2016

SPECIFICATIONS

CONFIGURATION:	34 Seats, Bedroom (front); 8 VIP, 8 Business, 18 Standard
RANGE:	10+ hours
LUGGAGE CAPACITY:	50-80 suitcases subject to weight and size
ENTERTAINMENT:	Video-on-demand IFE System, High-quality sound system with overhead speakers and subwoofers, World Map
CONNECTIVITY:	Ka-Band WiFi, GSM Phone, Cabin Satellite Phone, Fax
OTHER:	Low cabin altitude modification, HEPA filtration

NIGHT CONFIGURATION

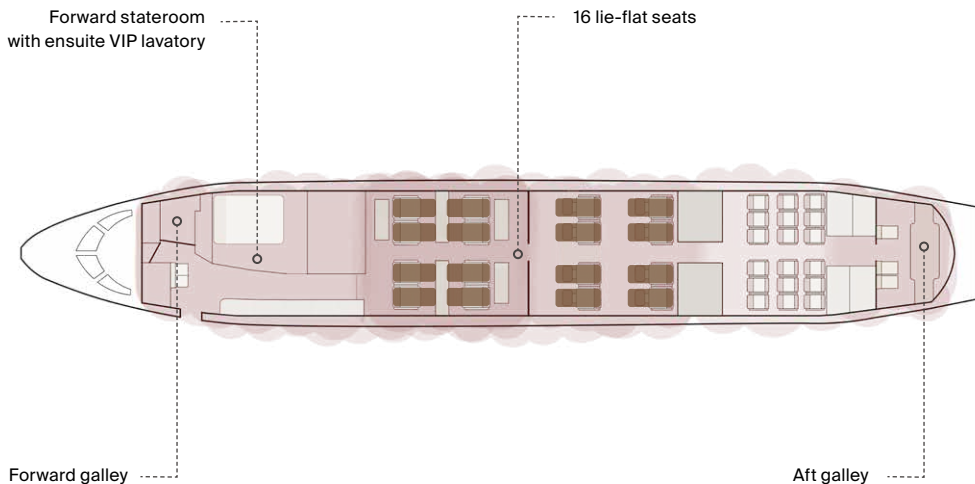

FLEET TYPE

<i>REGISTRATION:</i>	A6 RJU
<i>AIRCRAFT:</i>	Boeing Business Jet B737-77W
<i>YEAR OF MANUFACTURE:</i>	2015
<i>ENTRY INTO SERVICE:</i>	2016

SPECIFICATIONS

<i>BEDROOM:</i>	1 Bedroom (front)
<i>SEAT TO BED:</i>	 16 lie-flat seats
<i>SEAT RECLINE:</i>	18 Standard seats with 45° recline with no foot rest

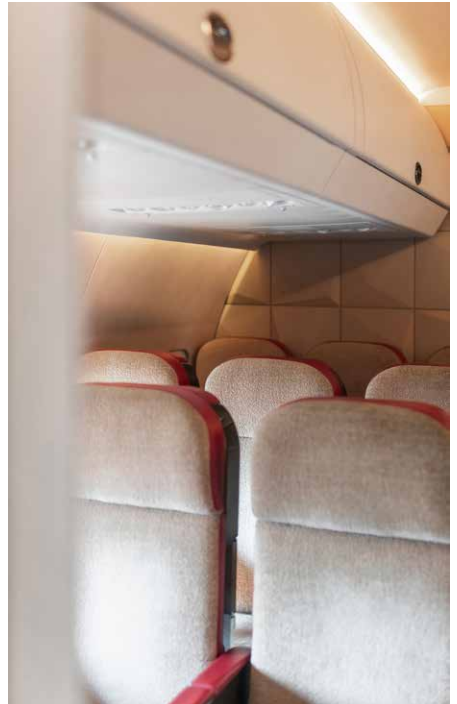
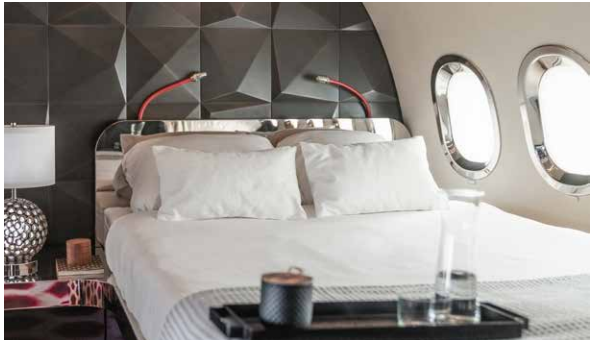

BOEING BUSINESS JET

A6 RJV

This aircraft is one of the newest in our fleet, having joined us fresh from the factory in 2017, and offers a forward stateroom with ensuite VIP lavatory, forward and aft galleys, a mid-cabin club / conference area, aft business class, and standard class seating.

The contemporary design of this aircraft features carbon fiber and premium materials throughout the cabin, along with a unique cool mood lighting system with over a million color variations, which is controlled by the customer operated iPad-based cabin management system.

This aircraft also boasts a state-of-the-art video-on-demand IFE System, enhanced by our high-quality sound system with overhead speakers and subwoofers, which can be controlled by the RoyalJet provided iPads or via the customer's own device. To maximize the value of this system for our guests, the aircraft has also been equipped with the highest speed communications system (Ka-Band WiFi) available globally. This system allows passengers to stream high definition video content throughout the flight, including via their own personal account with providers such as Apple TV, Netflix, and Amazon Prime Video.

A low cabin altitude modification and HEPA filtration are also featured, which optimize health and comfort, leaving passengers more relaxed and fresher upon reaching their destination.

The cabin configuration offers 34 seats via the mid cabin club eight arrangement, the eight mid/aft business class seats and the 18 aft standard class seats. For overnight or at any time of the flight, this aircraft features a queen-sized bed and 16 lie-flat seats.



DAY CONFIGURATION

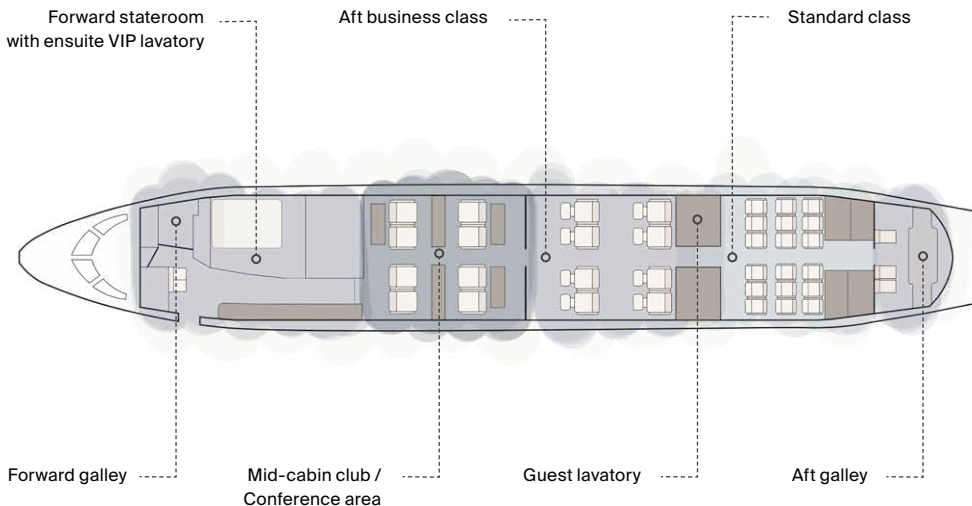

FLEET TYPE

REGISTRATION:	A6 RJV
AIRCRAFT:	Boeing Business Jet B737-77W
YEAR OF MANUFACTURE:	2015
ENTRY INTO SERVICE:	2016

SPECIFICATIONS

CONFIGURATION:	34 Seats, Bedroom (front); 8 VIP, 8 Business, 18 Standard
RANGE:	10+ hours
LUGGAGE CAPACITY:	50-80 suitcases subject to weight and size
ENTERTAINMENT:	Video-on-demand IFE System, High-quality sound system with overhead speakers and subwoofers, World Map
CONNECTIVITY:	Ka-Band WiFi, GSM Phone, Cabin Satellite Phone, Fax
OTHER:	Low cabin altitude modification, HEPA filtration

NIGHT CONFIGURATION

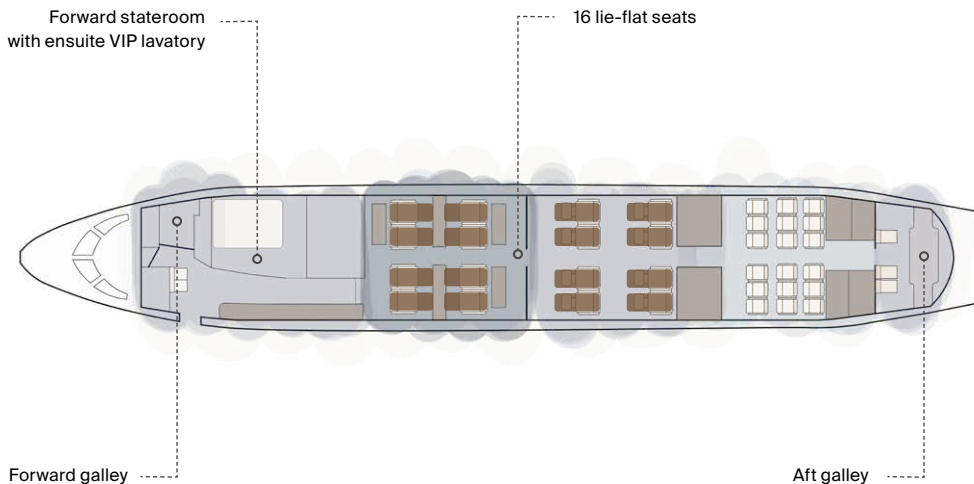

FLEET TYPE

<i>REGISTRATION:</i>	A6 RJV
<i>AIRCRAFT:</i>	Boeing Business Jet B737-77W
<i>YEAR OF MANUFACTURE:</i>	2015
<i>ENTRY INTO SERVICE:</i>	2016

SPECIFICATIONS

<i>BEDROOM:</i>	1 Bedroom (front)
<i>SEAT TO BED:</i>	 16 lie-flat seats
<i>SEAT RECLINE:</i>	18 Standard seats with 45° recline with no foot rest



BOEING BUSINESS JET

A6 DAS

This freshly refurbished and spectacular aircraft offers a VVIP interior which includes a forward stateroom with ensuite VIP lavatory, forward and aft galleys, club / conference seating and a VIP lounge (majlis) mid-cabin, aft business class, and standard class seating.

A comprehensive interior refurbishment was just completed on A6 DAS in 2021, utilizing state of the art materials and a design that reflects the culture and identity of Abu Dhabi and the UAE. This brand-new interior represents the launch of the RoyalJet customer experience transformation and features the very latest lighting, cabin management and in-flight entertainment systems which are complimented by a high-quality sound system including overhead speakers and subwoofers.

The aircraft has also been equipped with the highest speed communications system (Ka-Band WiFi) available globally, which allows passengers to stream high definition video content throughout the flight, including via their own personal accounts with providers such as Apple TV, Netflix and Amazon Prime Video.

A cabin humidifier system and HEPA filtration are also featured, which optimize health and comfort, leaving passengers more relaxed and fresher upon reaching their destination.

The cabin configuration offers flexibility between lower density (36 pax) or higher density (46 pax) depending on the client's preference and mission profile, and the aircraft is also capable of being converted into Medevac configuration via the installation of up to three ICU modules.

For a restful and comfortable trip overnight or at any time of the flight, this aircraft offers a queen-sized bed, 4 lie-flat seats, and from 8 to 16 seats reclinable up to 140°.



DAY CONFIGURATION

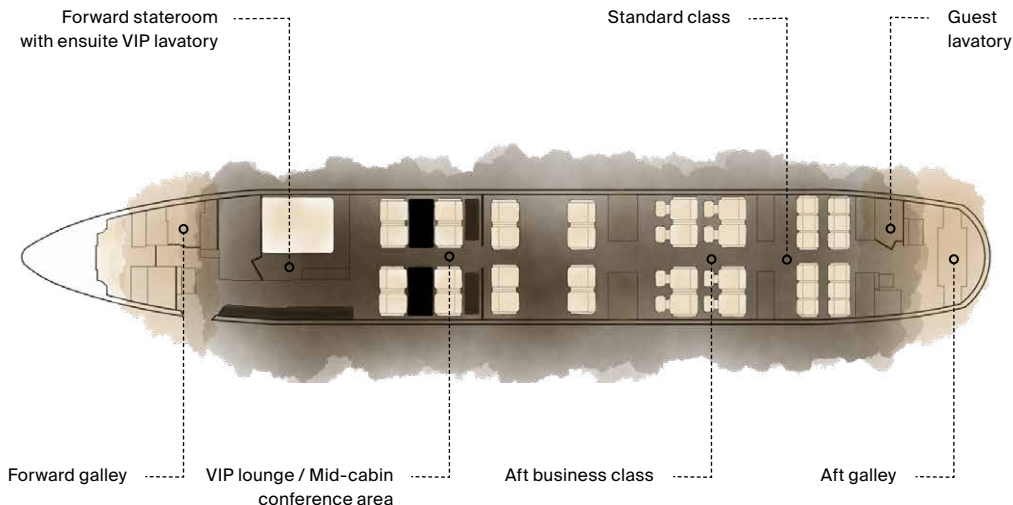

FLEET TYPE

REGISTRATION:	A6 DAS
AIRCRAFT:	Boeing Business Jet B737-700 IGW
YEAR OF MANUFACTURE:	2000
REFURBISHED:	2021

SPECIFICATIONS

CONFIGURATION A:	36 Seats, 1 Bedroom (front); 16 VIP, 8 Business, 12 Standard
RANGE:	9.5+ hours
LUGGAGE CAPACITY:	65-100 suitcases subject to weight and size
ENTERTAINMENT:	In-flight entertainment systems which allows passengers to stream high definition video content, High-quality sound system with overhead speakers and subwoofers, World Map
CONNECTIVITY:	Ka-Band WiFi, Cabin Satellite Phone, Fax
OTHER:	Cabin humidifier system, HEPA filtration

NIGHT CONFIGURATION

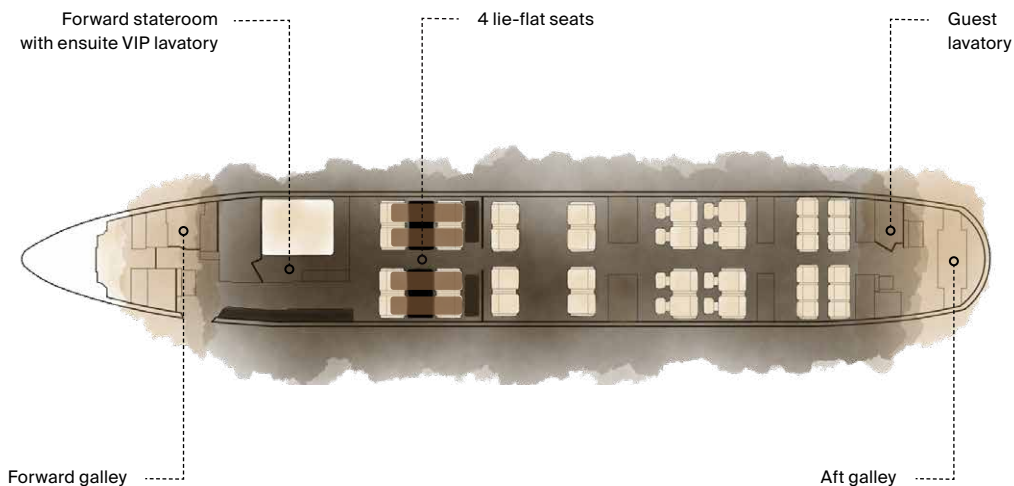

FLEET TYPE

<i>REGISTRATION:</i>	A6 DAS
<i>AIRCRAFT:</i>	Boeing Business Jet B737-700 IGW
<i>YEAR OF MANUFACTURE:</i>	2000
<i>REFURBISHED:</i>	2021

SPECIFICATIONS

<i>BEDROOM:</i>	1 Bedroom (front)
<i>SEAT TO BED:</i>	 8 seats to 4 beds via 4 lie-flat seats
<i>SEAT RECLINE:</i>	16 Business seats with 140° recline 12 Standard seats with 45° recline with no foot rest

DAY CONFIGURATION

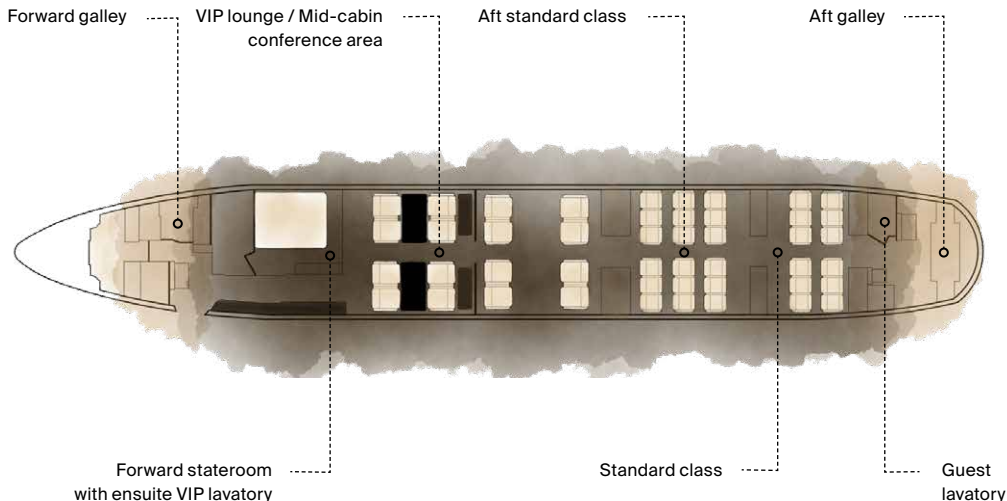

FLEET TYPE

REGISTRATION:	A6 DAS
AIRCRAFT:	Boeing Business Jet B737-700 IGW
YEAR OF MANUFACTURE:	2000
REFURBISHED:	2021

SPECIFICATIONS

CONFIGURATION B:	46 Seats, 1 Bedroom (front); 16 VIP, 30 Standard
RANGE:	9.5+ hours
LUGGAGE CAPACITY:	65-100 suitcases subject to weight and size
ENTERTAINMENT:	In-flight entertainment systems which allows passengers to stream high definition video content, High-quality sound system with overhead speakers and subwoofers, World Map
CONNECTIVITY:	Ka-Band WiFi, Cabin Satellite Phone, Fax
OTHER:	Cabin humidifier system, HEPA filtration

NIGHT CONFIGURATION

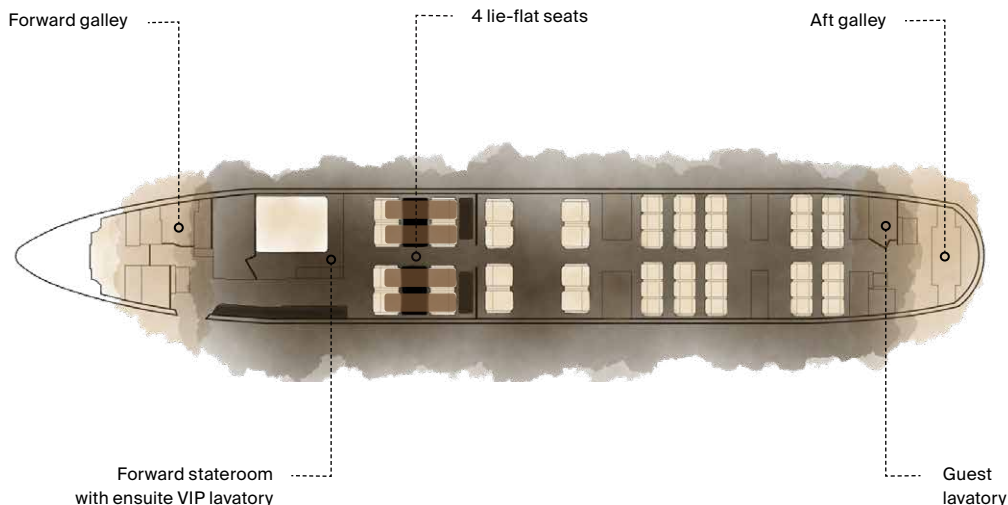

FLEET TYPE

<i>REGISTRATION:</i>	A6 DAS
<i>AIRCRAFT:</i>	Boeing Business Jet B737-700 IGW
<i>YEAR OF MANUFACTURE:</i>	2000
<i>REFURBISHED:</i>	2021

SPECIFICATIONS

<i>BEDROOM:</i>	1 Bedroom (front)
<i>SEAT TO BED:</i>	 8 seats to 4 beds via 4 lie-flat seats
<i>SEAT RECLINE:</i>	8 Business seats with 140° recline 30 Standard seats with 45° recline with no foot rest

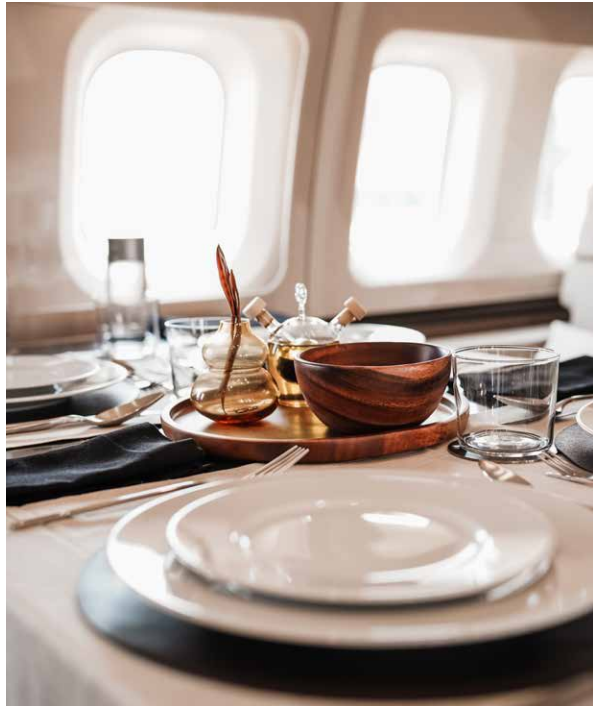

BOEING BUSINESS JET

A6 AIN

This beautiful recently upgraded aircraft offers a VVIP interior which includes a forward stateroom and ensuite VIP lavatory, forward and aft galleys, club/conference seating and a VIP lounge (majlis) mid-cabin, and aft business class and standard class seating.

A full interior refurbishment was done on this aircraft in 2014 using premium materials such as Ostrich skin and high gloss wood veneer. It also features a state-of-the-art iPad-controlled IFE System, a high-quality sound system which includes overhead speakers and subwoofers, and HEPA filtration which optimize passenger health and comfort.

In late 2020, further interior touch-ups were completed and communications were upgraded to the latest and highest speed system (Ka-Band WiFi) available globally. This system allows for streaming of high definition video content, including via passengers' own accounts with providers such as Apple TV, Netflix, and Amazon Prime Video.

The cabin configuration offers flexibility between lower density (36 pax), or higher density (46 pax) depending on the client's preference and mission profile, and the aircraft is also capable of being converted into Medevac configuration via the installation of up to three ICU modules.

For a restful and comfortable trip overnight or at any time of the flight, this aircraft offers a queen-sized bed, 4 lie-flat seats and up to 24 seats reclinable to 140°.



DAY CONFIGURATION

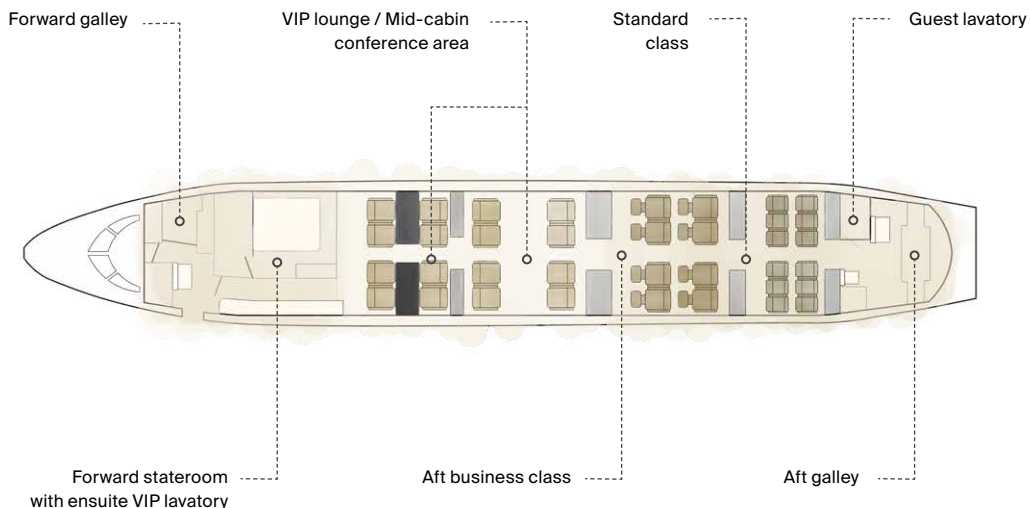

FLEET TYPE

REGISTRATION:	A6 AIN
AIRCRAFT:	Boeing Business Jet B737-700 IGW
YEAR OF MANUFACTURE:	1999
REFURBISHED:	2014

SPECIFICATIONS

CONFIGURATION A:	36 Seats, 1 Bedroom (front); 16 VIP, 8 Business, 12 Standard
RANGE:	9.5+ hours
LUGGAGE CAPACITY:	65-100 suitcases subject to weight and size
ENTERTAINMENT:	State-of-the-art iPad-controlled IFE System, High-quality sound system with overhead speakers and subwoofers
CONNECTIVITY:	Ka-Band WiFi, GSM Phone, Cabin Satellite Phone, Fax
OTHER:	HEPA filtration

NIGHT CONFIGURATION

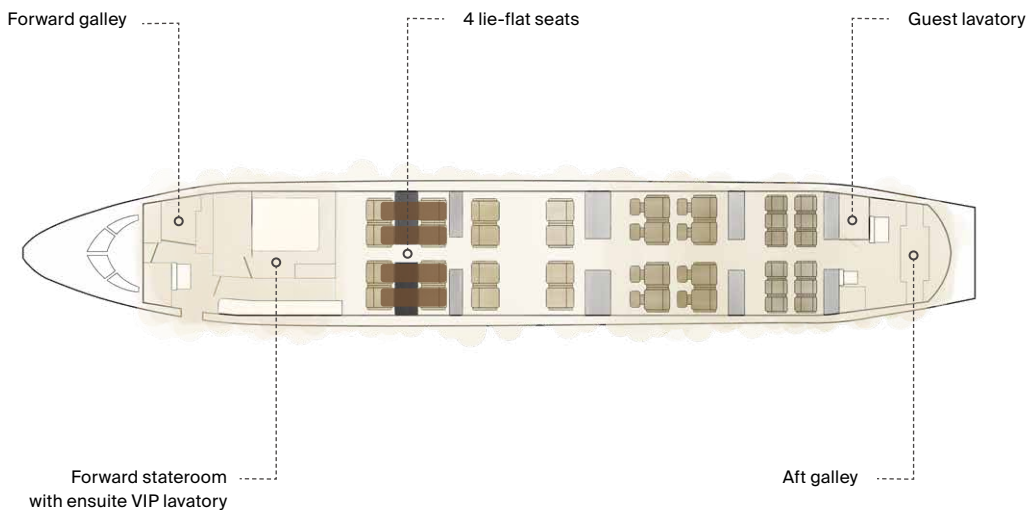

FLEET TYPE

<i>REGISTRATION:</i>	A6 AIN
<i>AIRCRAFT:</i>	Boeing Business Jet B737-700 IGW
<i>YEAR OF MANUFACTURE:</i>	1999
<i>REFURBISHED:</i>	2014

SPECIFICATIONS

<i>BEDROOM:</i>	1 Bedroom (front)
<i>SEAT TO BED:</i>	 8 seats to 4 beds via 4 lie-flat seats
<i>SEAT RECLINE:</i>	16 Business seats with 140° recline 12 Standard seats with 45° recline with no foot rest

DAY CONFIGURATION

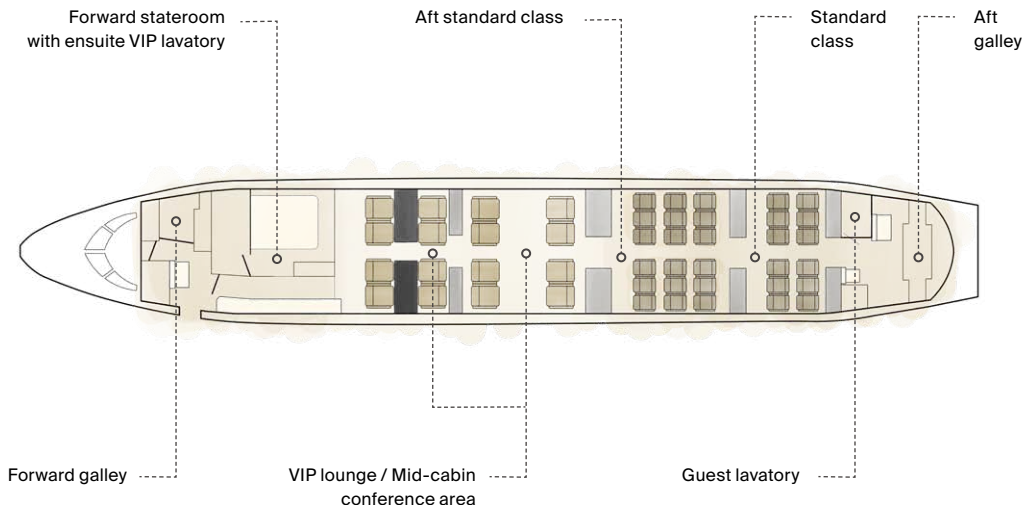

FLEET TYPE

<i>REGISTRATION:</i>	A6 AIN
<i>AIRCRAFT:</i>	Boeing Business Jet B737-700 IGW
<i>YEAR OF MANUFACTURE:</i>	1999
<i>REFURBISHED:</i>	2014

SPECIFICATIONS

<i>CONFIGURATION B:</i>	46 Seats, 1 Bedroom (front); 16 VIP, 30 Standard
<i>RANGE:</i>	9.5+ hours
<i>LUGGAGE CAPACITY:</i>	65-100 suitcases subject to weight and size
<i>ENTERTAINMENT:</i>	State-of-the-art iPad-controlled IFE System, High-quality sound system with overhead speakers and subwoofers
<i>CONNECTIVITY:</i>	Ka-Band WiFi, GSM Phone, Cabin Satellite Phone, Fax
<i>OTHER:</i>	HEPA filtration

NIGHT CONFIGURATION

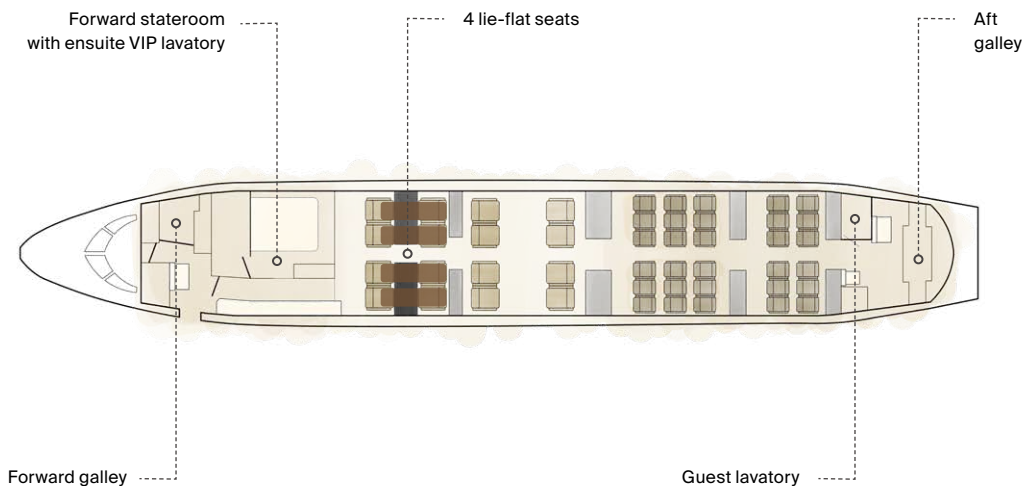

FLEET TYPE

<i>REGISTRATION:</i>	A6 AIN
<i>AIRCRAFT:</i>	Boeing Business Jet B737-700 IGW
<i>YEAR OF MANUFACTURE:</i>	1999
<i>REFURBISHED:</i>	2014

SPECIFICATIONS

<i>BEDROOM:</i>	1 Bedroom (front)
<i>SEAT TO BED:</i>	 8 seats to 4 beds via 4 lie-flat seats
<i>SEAT RECLINE:</i>	8 Business seats with 140° recline 30 Standard seats with 45° recline with no foot rest



BOEING BUSINESS JET

A6 RJX

This beautiful aircraft offers a forward VVIP lounge (majlis), forward and aft galleys, business class seating mid-cabin, and an aft stateroom with ensuite VIP lavatory.

The interior of this aircraft was refurbished in 2007 utilizing premium materials including high quality leather and dark wood laminates. It is one of our longest-range aircraft and therefore includes a forward crew rest area for longer missions. The aircraft also features a CMS controlled lighting system, a broadcast IFE System and a high-quality sound system including overhead speakers and subwoofers.

HEPA filtration is also featured, which optimizes health and comfort, leaving passengers more relaxed and fresh upon reaching their destination.

The cabin configuration offers 30 passenger seats, including 6 seats in the VVIP lounge and 24 identical business class seats mid-cabin. The bedroom can also be converted into an office or entertainment lounge, with the bed converting into a divan with in-flight seating for two.

For a restful and comfortable trip overnight or at any time of the flight, this aircraft offers a queen-sized bed, a small single sleeper divan, 4 lie-flat seats and 24 seats reclinable up to 145°.



DAY CONFIGURATION

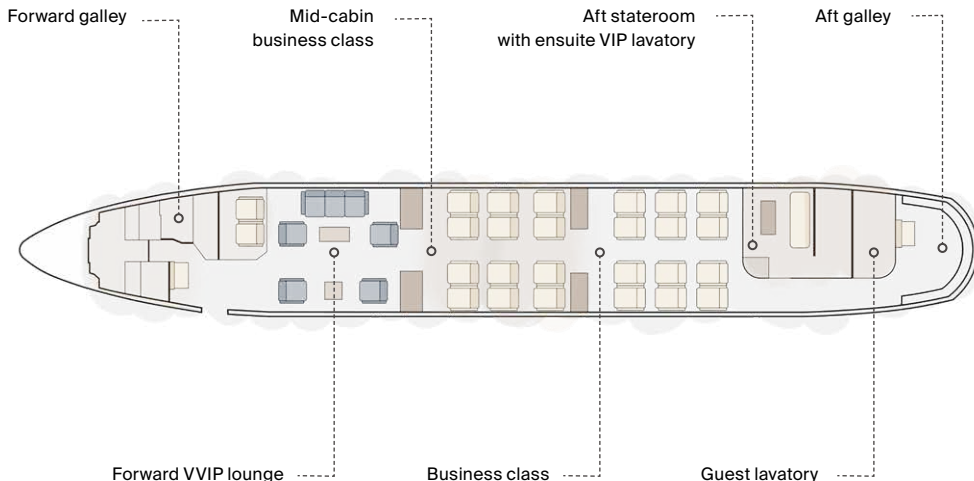

FLEET TYPE

<i>REGISTRATION:</i>	A6 RJX
<i>AIRCRAFT:</i>	Boeing Business Jet B737-700 IGW
<i>YEAR OF MANUFACTURE:</i>	1999
<i>REFURBISHED:</i>	2007

SPECIFICATIONS

<i>CONFIGURATION:</i>	30 Seats, 1 Bedroom (rear); 28 VIP, 2 on divan
<i>RANGE:</i>	10.5+ hours
<i>LUGGAGE CAPACITY:</i>	30-50 suitcases subject to weight and size
<i>ENTERTAINMENT:</i>	Broadcast IFE System, High-quality sound system with overhead speakers and subwoofers, World Map
<i>CONNECTIVITY:</i>	Cabin Satellite Phone, Fax
<i>OTHER:</i>	HEPA filtration, CMS controlled lighting system

NIGHT CONFIGURATION

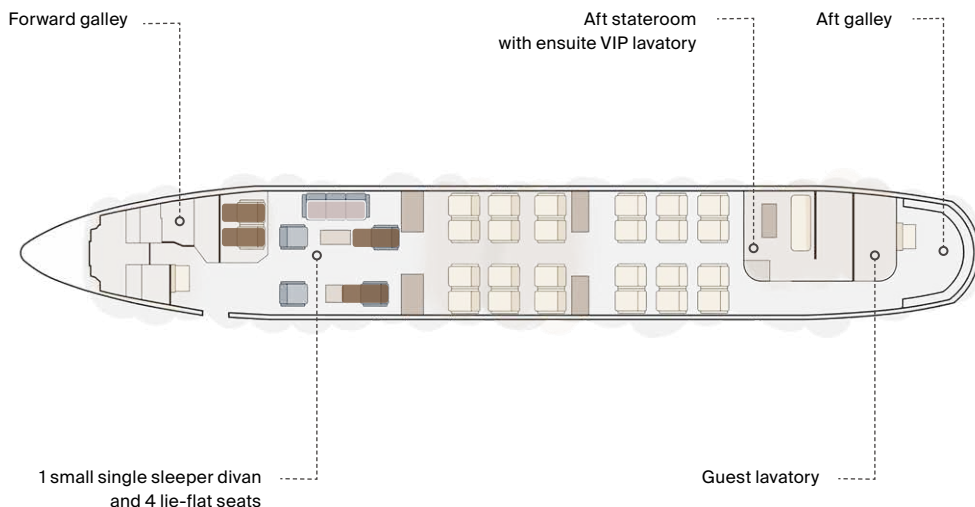

FLEET TYPE

<i>REGISTRATION:</i>	A6 RJX
<i>AIRCRAFT:</i>	Boeing Business Jet B737-700 IGW
<i>YEAR OF MANUFACTURE:</i>	1999
<i>REFURBISHED:</i>	2007

SPECIFICATIONS

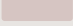
<i>BEDROOM:</i>	1 Bedroom (back)
<i>SEAT TO BED:</i>	 4 lie-flat seats  1 small single sleeper divan
<i>SEAT RECLINE:</i>	24 Business seats with 145° recline



BOEING BUSINESS JET

A6 RJY

This beautiful aircraft offers a forward VVIP lounge (majlis) and VIP lavatory, forward and aft galleys, mid-cabin club / conference groupings and aft business class and standard class seating.

A comprehensive reconfiguration and refurbishment was completed on this aircraft in 2010 utilizing premium materials and state-of-the-art systems. It features Swift Broadband WiFi, a modern IFE System, mood lighting controls (which include a starlit night sky option) and a high-quality sound system with overhead speakers and subwoofers.

HEPA filtration is also featured, which optimizes health and comfort, leaving passengers more relaxed and fresh upon reaching their destination.

The cabin configuration offers seats for up to 40 passengers, and the aircraft is also capable of being converted into Medevac configuration via the installation of up to two ICU modules.

For a restful and comfortable trip overnight or at any time of the flight, this aircraft offers two single sleeper divans, 18 lie-flat seats and 4 seats reclinable to 120°.



DAY CONFIGURATION

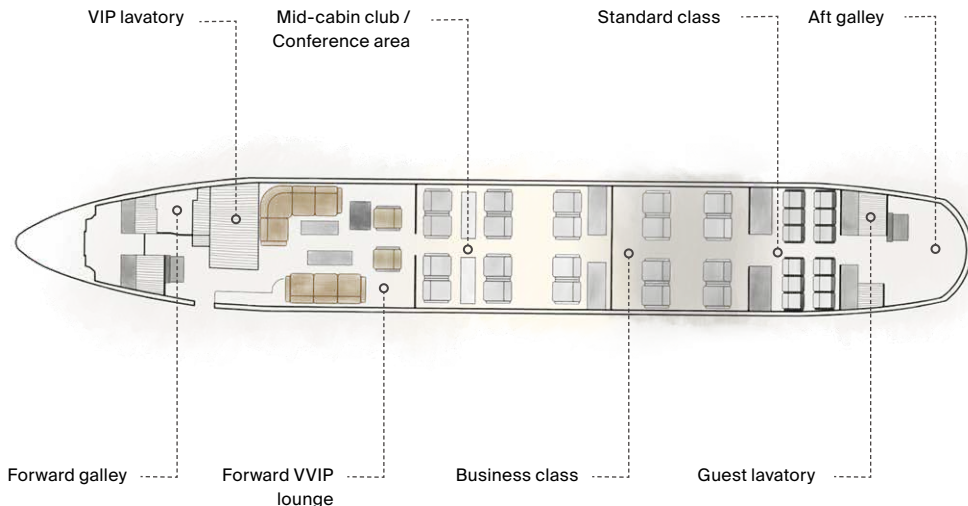

FLEET TYPE

REGISTRATION:	A6 RJY
AIRCRAFT:	Boeing Business Jet B737-700 IGW
YEAR OF MANUFACTURE:	1999
REFURBISHED:	2010

SPECIFICATIONS

CONFIGURATION:	40 Seats; 22 VIP, 12 Standard, 6 on divan
RANGE:	9.5+ hours
LUGGAGE CAPACITY:	65-100 suitcases subject to weight and size
ENTERTAINMENT:	Modern IFE System, High-quality sound system with overhead speakers and subwoofers, World Map
CONNECTIVITY:	Swift Broadband WiFi, Cabin Satellite Phone, Fax
OTHER:	HEPA filtration

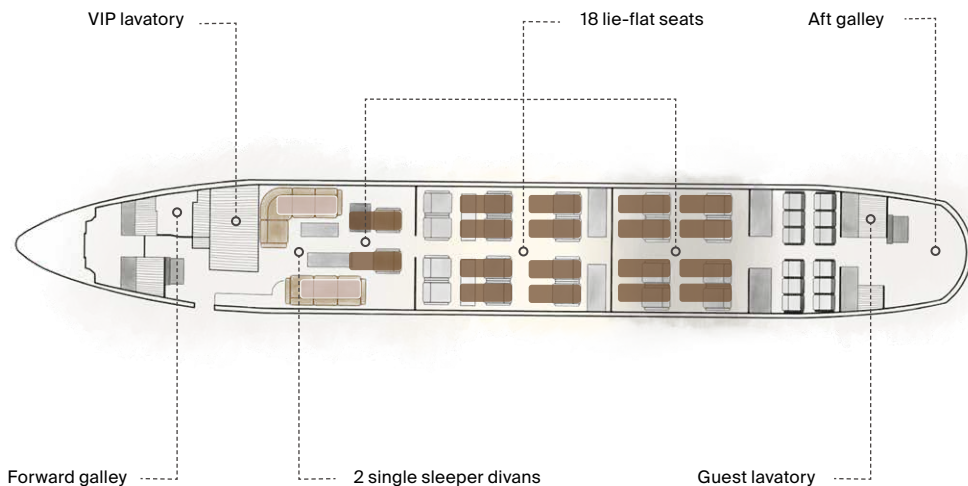

NIGHT CONFIGURATION



FLEET TYPE

<i>REGISTRATION:</i>	A6 RJY
<i>AIRCRAFT:</i>	Boeing Business Jet B737-700 IGW
<i>YEAR OF MANUFACTURE:</i>	1999
<i>REFURBISHED:</i>	2010

SPECIFICATIONS

<i>SEAT TO BED:</i>	20 beds;
	 18 lie-flat seats
	 2 single sleeper divans

<i>SEAT RECLINE:</i>	4 Business seats with 120° recline
	12 Standard seats with 45° recline with no foot rest

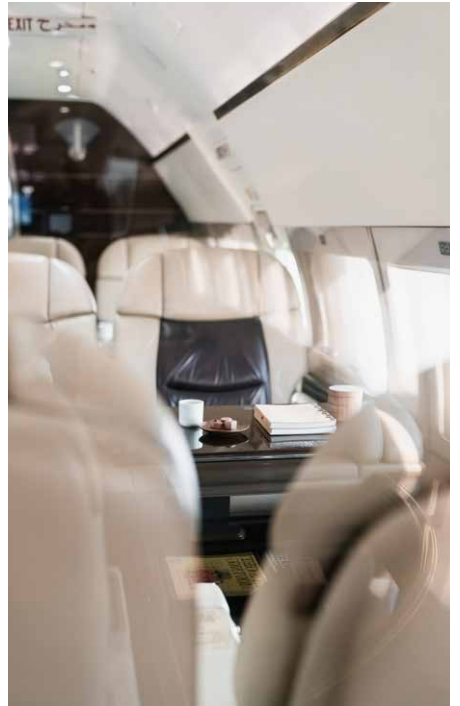

BOEING BUSINESS JET

A6 RJZ

This beautiful aircraft offers forward and mid cabin club/conference groupings, a forward VIP lavatory, forward and aft galleys, aft business class, and standard class seating.

The interior of this aircraft was created utilizing premium materials, including high end leathers and gloss wood veneers, and state-of-the-art systems. It features a broadcast IFE System and lighting controls via the cabin management system and is also equipped with a high-quality sound system including overhead speakers and subwoofers.

HEPA filtration is also featured, which optimizes health and comfort, leaving passengers more relaxed and fresh upon reaching their destination.

The cabin configuration offers flexibility between lower density (42 pax), or higher density (52 pax) depending on the client's preference and mission profile, and the aircraft is also capable of being converted into Medevac configuration via the installation of up to four ICU modules.

For a restful and comfortable trip overnight or at any time of the flight, this aircraft is equipped with up to 30 lie-flat or 140° reclining seats.



DAY CONFIGURATION

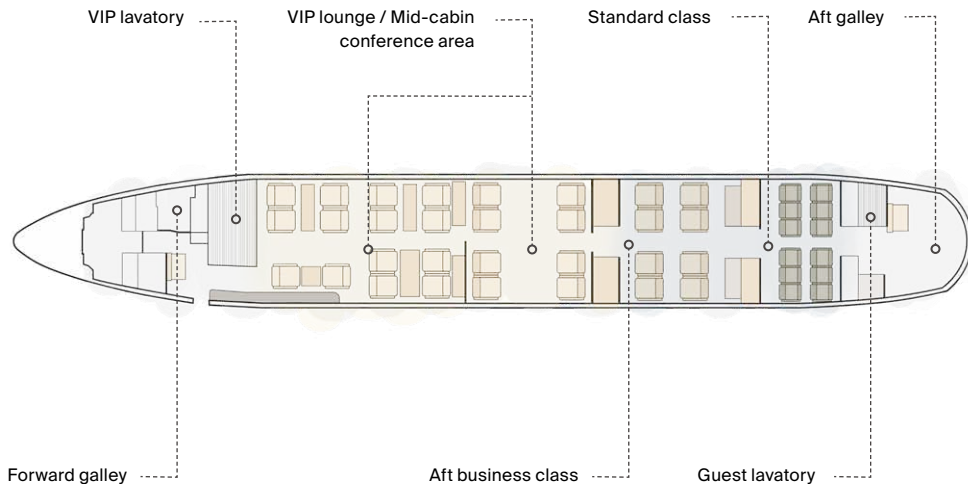

FLEET TYPE

REGISTRATION:	A6 RJZ
AIRCRAFT:	Boeing Business Jet B737-700 IGW
YEAR OF MANUFACTURE:	1999

SPECIFICATIONS

CONFIGURATION A:	42 Seats; 22 VIP, 8 Business, 12 Standard
RANGE:	9.5+ hours
LUGGAGE CAPACITY:	65-100 suitcases subject to weight and size
ENTERTAINMENT:	Broadcast IFE System, High-quality sound system with overhead speakers and subwoofers, World Map
CONNECTIVITY:	Cabin Satellite Phone, Fax
OTHER:	HEPA filtration

NIGHT CONFIGURATION

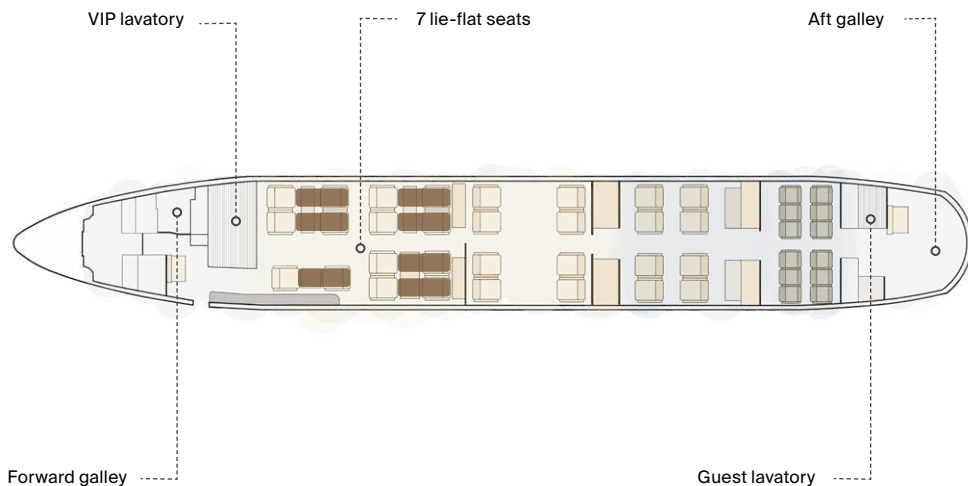

FLEET TYPE

REGISTRATION:	A6 RJZ
AIRCRAFT:	Boeing Business Jet B737-700 IGW
YEAR OF MANUFACTURE:	1999

SPECIFICATIONS

SEAT TO BED:	 14 seats to 7 beds via 7 lie-flat seats
SEAT RECLINE:	16 Business seats with 140° recline 12 Standard seats with 45° recline with no foot rest

DAY CONFIGURATION

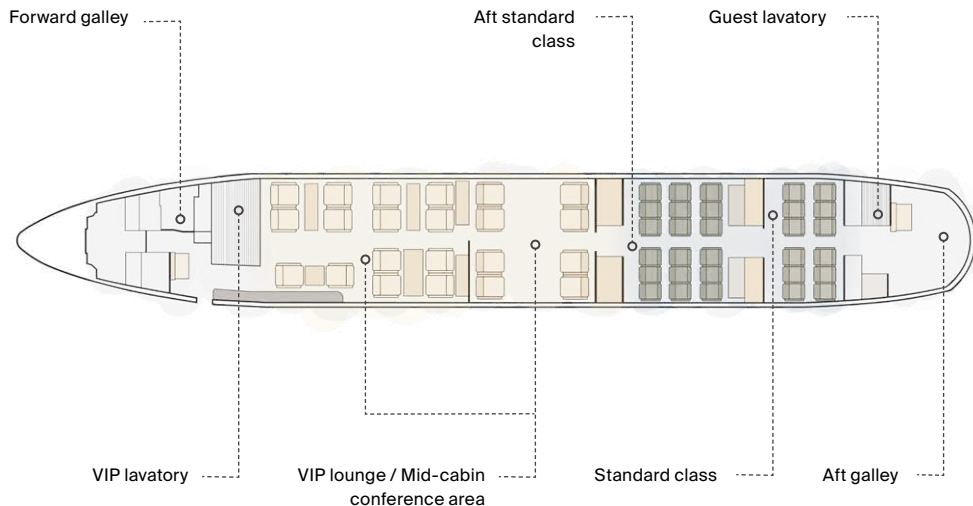

FLEET TYPE

REGISTRATION:	A6 RJZ
AIRCRAFT:	Boeing Business Jet B737-700 IGW
YEAR OF MANUFACTURE:	1999

SPECIFICATIONS

CONFIGURATION B:	52 Seats; 22 VIP, 30 Standard
RANGE:	9.5+ hours
LUGGAGE CAPACITY:	65-100 suitcases subject to weight and size
ENTERTAINMENT:	Broadcast IFE System, High-quality sound system with overhead speakers and subwoofers, World Map
CONNECTIVITY:	Cabin Satellite Phone, Fax
OTHER:	HEPA filtration

NIGHT CONFIGURATION

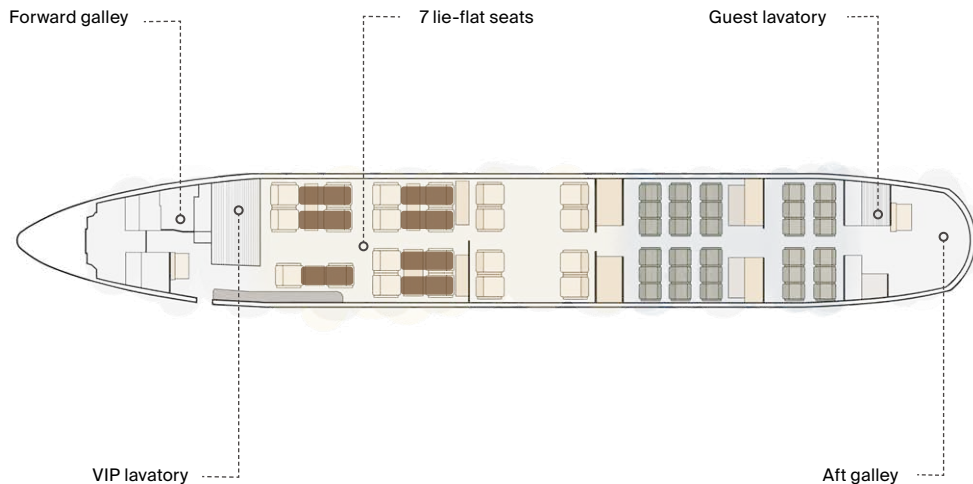

FLEET TYPE

<i>REGISTRATION:</i>	A6 RJZ
<i>AIRCRAFT:</i>	Boeing Business Jet B737-700 IGW
<i>YEAR OF MANUFACTURE:</i>	1999

SPECIFICATIONS

<i>SEAT TO BED:</i>	 14 seats to 7 beds via 7 lie-flat seats
<i>SEAT RECLINE:</i>	8 Business seats with 140° recline 30 Standard seats with 45° recline with no foot rest



BOEING BUSINESS JET

A6 DFR

This beautiful aircraft offers two large forward and mid VVIP lounges (majlis), a forward galley and crew rest area (for longer missions), a mid-cabin VVIP lavatory with shower, a spacious aft private office and a beautiful aft stateroom and an expansive ensuite VIP lavatory with shower.

The interior of this aircraft was refurbished in 2010 utilizing premium materials including high-quality leather and dark wood laminates. The aircraft also features a CMS controlled lighting system, a broadcast IFE System and a high-quality sound system including overhead speakers and subwoofers.

HEPA filtration is also featured, which optimizes health and comfort, leaving passengers more relaxed and fresh upon reaching their destination.

The cabin configuration offers 19 passenger seats in the two lounges, including 4 single VVIP seats and 15 seats on the various divans. The 4 seats in the office and the three crew rest seats can also be utilized during flight, and the office can be converted into a second bedroom.

For a restful and comfortable trip overnight or at any time of the flight, this aircraft offers a queen-sized bed, 4 single sleeper divans, 4 lie-flat VVIP seats and 2 seats reclinable up to 140°.



DAY CONFIGURATION

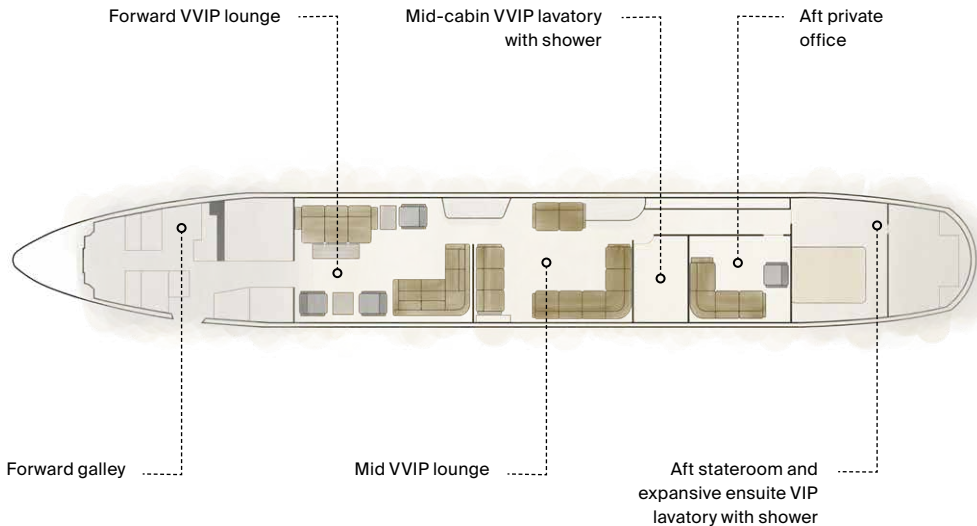

FLEET TYPE

<i>REGISTRATION:</i>	A6 DFR
<i>AIRCRAFT:</i>	Boeing Business Jet B737-700 IGW
<i>YEAR OF MANUFACTURE:</i>	2000
<i>REFURBISHED:</i>	2010

SPECIFICATIONS

<i>CONFIGURATION:</i>	19 Seats, 1 Bedroom (back); 4 VIP seats, 15 on divan
<i>RANGE:</i>	10.5+ hours
<i>LUGGAGE CAPACITY:</i>	30-50 suitcases subject to weight and size
<i>ENTERTAINMENT:</i>	Broadcast IFE System, High-quality sound system with overhead speakers and subwoofers, World Map, Live TV
<i>CONNECTIVITY:</i>	Cabin Satellite Phone, Fax
<i>OTHER:</i>	HEPA filtration, CMS controlled lighting system

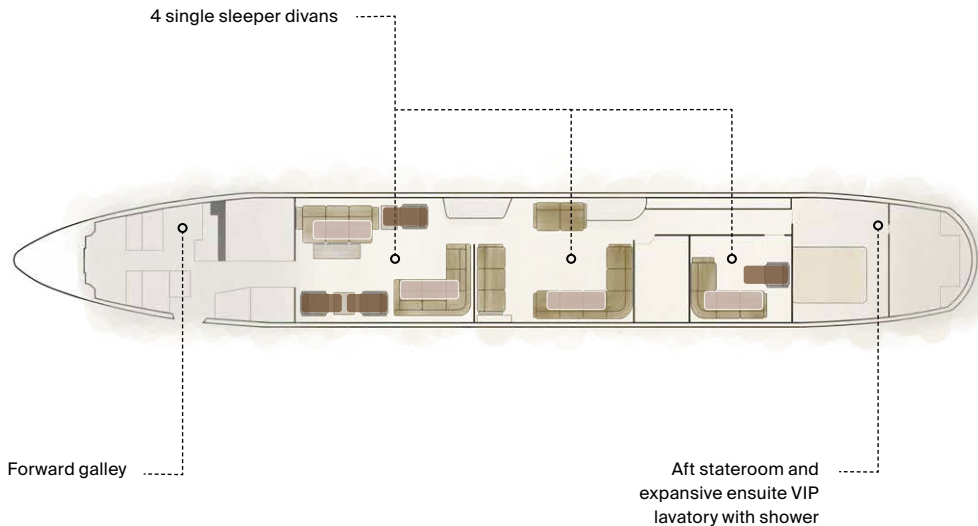

NIGHT CONFIGURATION



FLEET TYPE

<i>REGISTRATION:</i>	A6 DFR
<i>AIRCRAFT:</i>	Boeing Business Jet B737-700 IGW
<i>YEAR OF MANUFACTURE:</i>	2000
<i>REFURBISHED:</i>	2010

SPECIFICATIONS

<i>BEDROOM:</i>	1 Bedroom (back)
<i>SEAT TO BED:</i>	 4 lie-flat VVIP seats
	 4 single sleeper divans
<i>SEAT RECLINE:</i>	2 seats with 140° recline



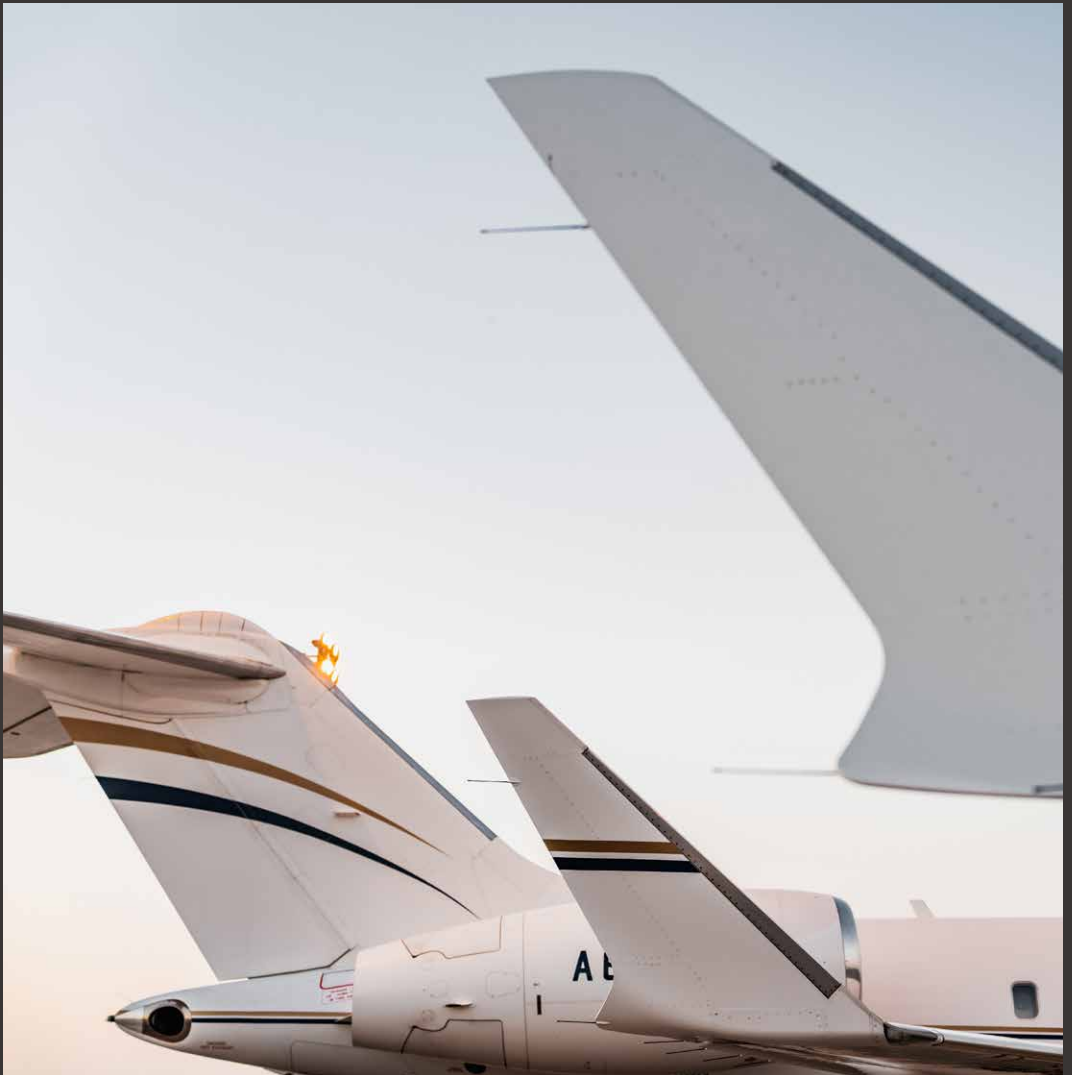

Bombardier Global

BOMBARDIER GLOBAL

A6 RJC

These beautiful aircraft are two of the youngest in our fleet, having joined us fresh from the factory in 2015. Their interiors are classically designed, with a forward galley, a forward club four grouping, a mid-cabin conference arrangement and an aft VVIP lounge (majlis) with a VIP lavatory.

The interiors of these aircraft were developed utilizing premium materials such as high end leathers and beautiful wood veneers. They also incorporate state-of-the-art systems, including Swift Broadband WiFi, an iPad-controlled IFE System, mood lighting, and a high-quality sound system with overhead speakers and subwoofers.

These aircraft feature some of the lowest cabin altitudes in the industry, along with HEPA filters, which optimize health and comfort, leaving passengers more relaxed and fresh upon reaching their destination.

The cabin configuration offers 13 passenger seats, via the forward club four, mid cabin conference four and the aft 3 place divan across from the club two.

For overnight or for rest at any time of the flight, this aircraft offers a single sleeper divan, 4 VIP seats which recline up to 140°, and 6 seats with 110° recline.



DAY CONFIGURATION

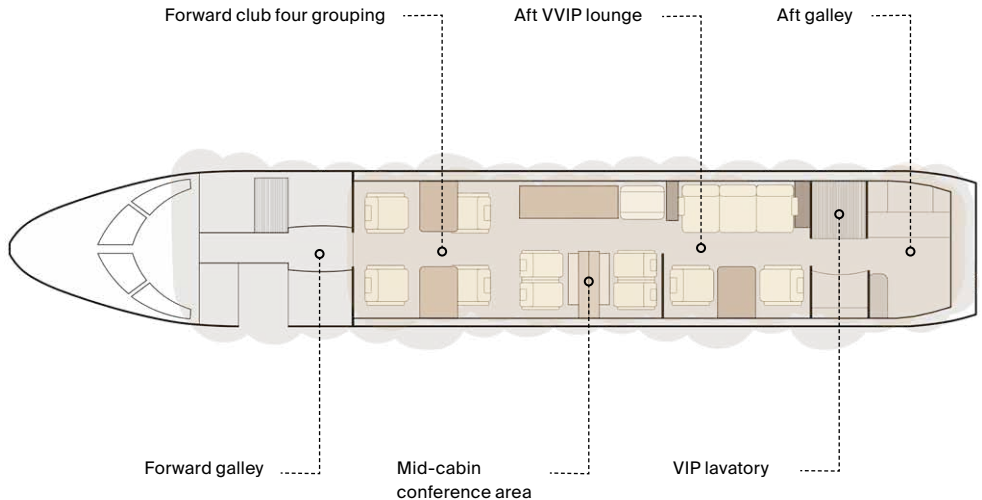

FLEET TYPE

<i>REGISTRATION:</i>	A6 RJC
<i>AIRCRAFT:</i>	Bombardier Global 5000 Vision
<i>YEAR OF MANUFACTURE:</i>	2014
<i>ENTRY INTO SERVICE:</i>	2015

SPECIFICATIONS

<i>CONFIGURATION B:</i>	12 Seats, 10 VIP Seats, 2 on divan
<i>RANGE:</i>	11+ hours
<i>LUGGAGE CAPACITY:</i>	18-25 standard cases subject to weight and size
<i>ENTERTAINMENT:</i>	iPad-controlled IFE System, High-quality sound system with overhead speakers and subwoofers
<i>CONNECTIVITY:</i>	Swift Broadband WiFi, Cabin Satellite Phone, Fax
<i>OTHER:</i>	Low cabin altitude modification, HEPA filtration

NIGHT CONFIGURATION

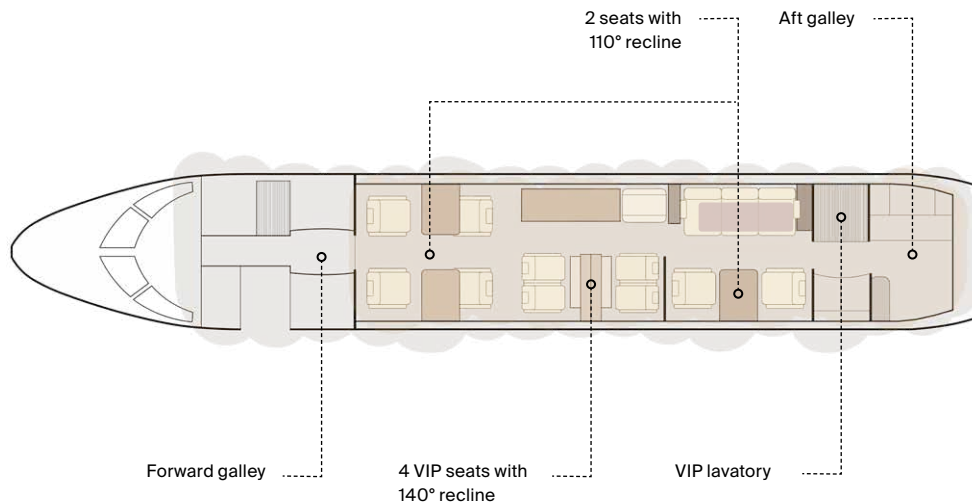

FLEET TYPE

<i>REGISTRATION:</i>	A6 RJC
<i>AIRCRAFT:</i>	Bombardier Global 5000 Vision
<i>YEAR OF MANUFACTURE:</i>	2014
<i>ENTRY INTO SERVICE:</i>	2015

SPECIFICATIONS

<i>SEAT TO BED:</i>	 Single sleeper divan
<i>SEAT RECLINE:</i>	4 VIP seats with 140° recline 6 seats with 110° recline



BOMBARDIER GLOBAL

A6 RJD

These beautiful aircraft are two of the youngest in our fleet, having joined us fresh from the factory in 2015. Their interiors are classically designed, with a forward galley, a forward club four grouping, a mid-cabin conference arrangement and an aft VVIP lounge (majlis) with a VIP lavatory.

The interiors of these aircraft were developed utilizing premium materials such as high end leathers and beautiful wood veneers. They also incorporate state of the art systems, including Swift Broadband WiFi, an iPad-controlled IFE System, mood lighting, and a high-quality sound system with overhead speakers and subwoofers.

These aircraft feature some of the lowest cabin altitudes in the industry, along with HEPA filters, which optimize health and comfort, leaving passengers more relaxed and fresh upon reaching their destination.

The cabin configuration offers 13 passenger seats, via the forward club four, mid cabin conference four and the aft 3 place divan across from the club two.

For overnight or for rest at any time of the flight, this aircraft offers a single sleeper divan, 4 VIP seats which recline up to 140°, and 6 seats with 110° recline.



DAY CONFIGURATION

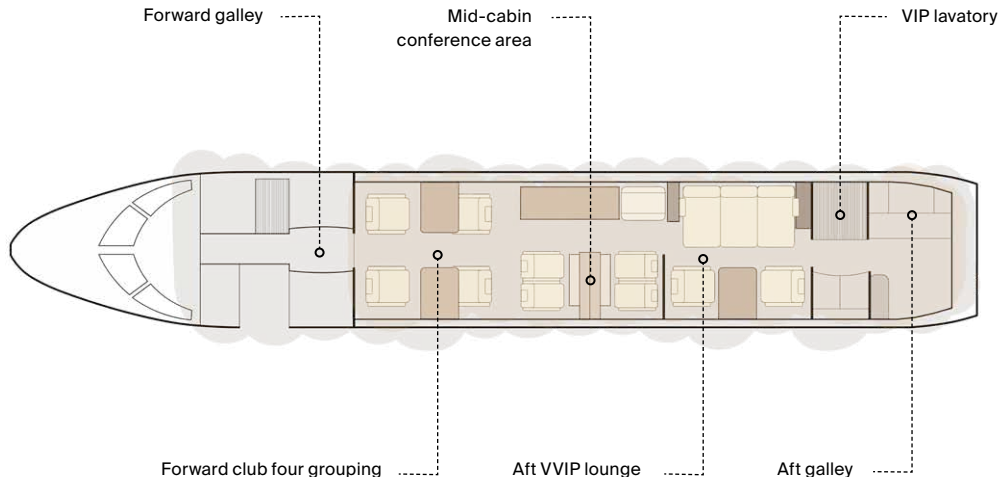

FLEET TYPE

<i>REGISTRATION:</i>	A6 RJD
<i>AIRCRAFT:</i>	Bombardier Global 5000 Vision
<i>YEAR OF MANUFACTURE:</i>	2014
<i>ENTRY INTO SERVICE:</i>	2014

SPECIFICATIONS

<i>CONFIGURATION:</i>	12 Seats, 10 VIP Seats, 2 on divan
<i>RANGE:</i>	11+ hours
<i>LUGGAGE CAPACITY:</i>	18-25 standard cases subject to weight and size
<i>ENTERTAINMENT:</i>	iPad-controlled IFE System, High-quality sound system with overhead speakers and subwoofers
<i>CONNECTIVITY:</i>	Swift Broadband WiFi, Cabin Satellite Phone, Fax
<i>OTHER:</i>	Low cabin altitude modification, HEPA filtration

NIGHT CONFIGURATION

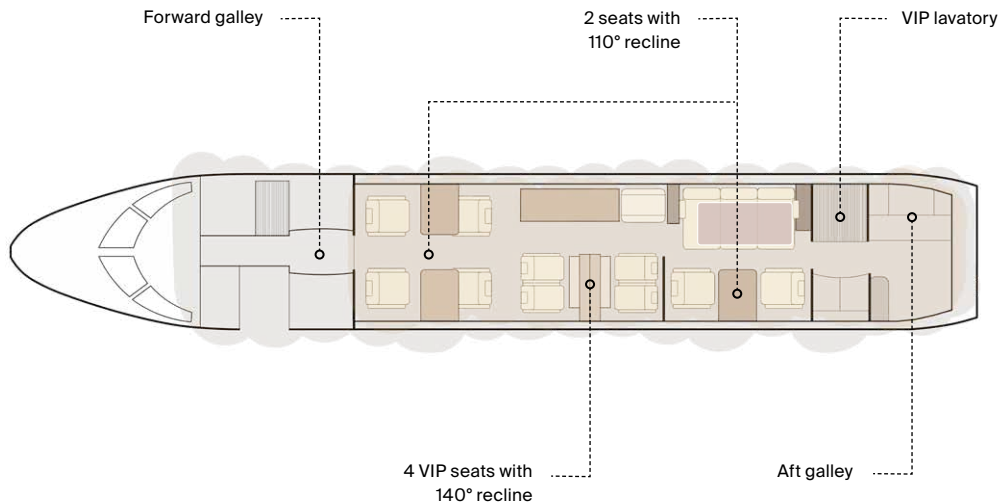

FLEET TYPE

<i>REGISTRATION:</i>	A6 RJD
<i>AIRCRAFT:</i>	Bombardier Global 5000 Vision
<i>YEAR OF MANUFACTURE:</i>	2014
<i>ENTRY INTO SERVICE:</i>	2014

SPECIFICATIONS

<i>SEAT TO BED:</i>	 Single sleeper divan
<i>SEAT RECLINE:</i>	4 VIP seats with 140° recline 6 seats with 110° recline



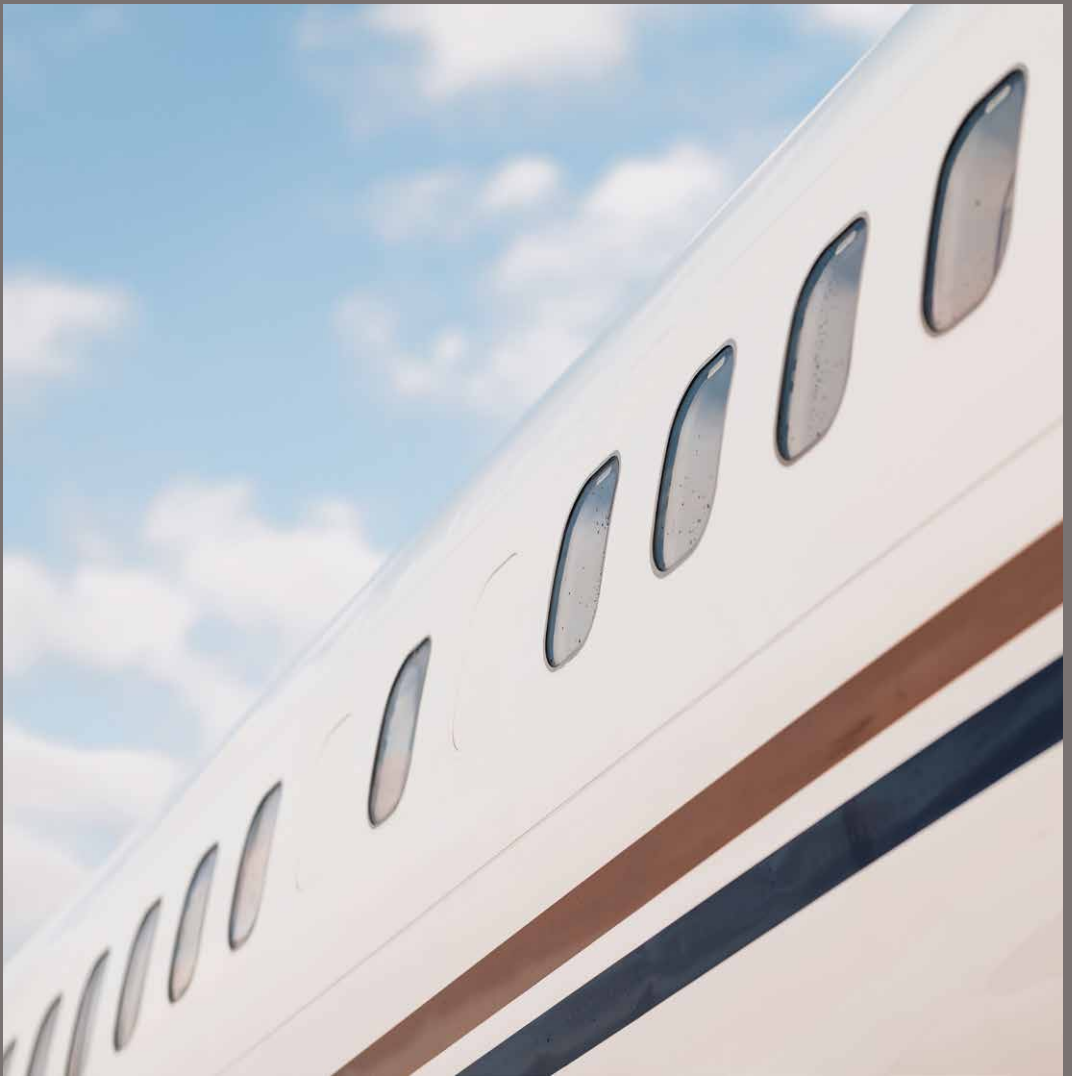

Medical Evacuation

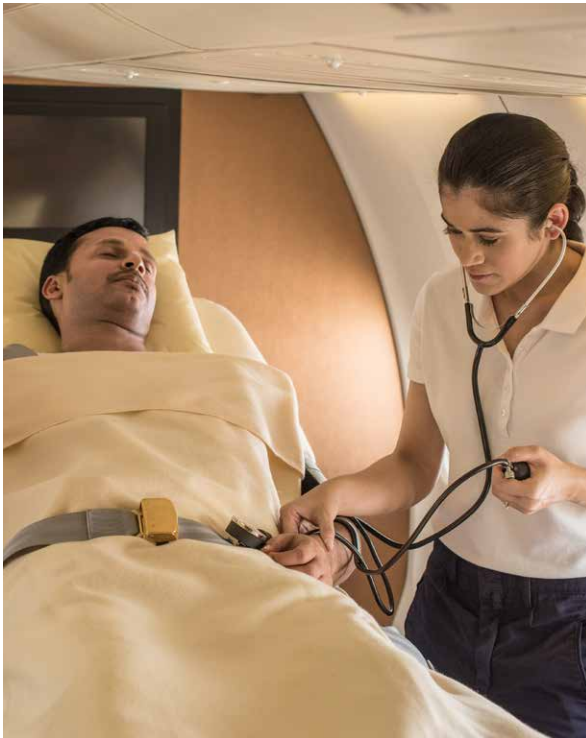

The pioneer of aeromedical evacuation in the Middle East

Alongside our success in premium private aviation, RoyalJet has also become the leading aeromedical evacuation service in the Middle East.

Whether you're arranging support for an individual patient, or an urgent mass evacuation, we can dispatch a fully equipped aircraft within two to three hours of your call, staffed by a highly trained medical team. Our doctors and nurses specialize in critical and emergency care, including neonatal, pediatric and cardiac treatment. Each aircraft is equipped with the most advanced medical technology, including neonatal ventilators and defibrillators and a wide range of mobile critical care equipment.

MEDEVAC CONFIGURATION

One (1) Bed Layout

CONFIG CONTROL NO.: MED1-BBJ-A

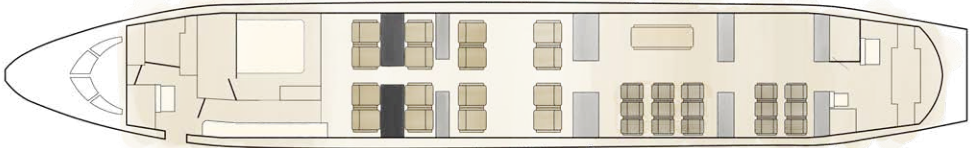

CONFIG CONTROL NO.: MED1-BBJ-B

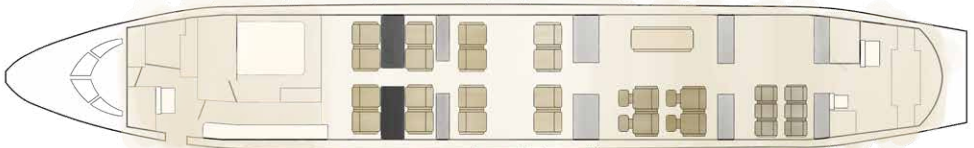

CONFIG CONTROL NO.: MED1-BBJ-C

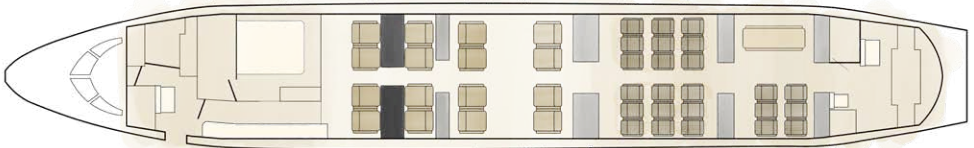

CONFIG CONTROL NO.: MED1-BBJ-D

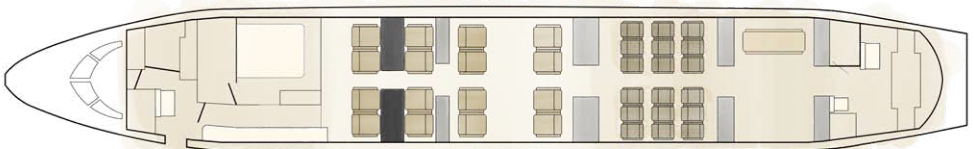

SPECIFICATIONS

EFFECTIVITY: A6 AIN, A6 DAS, A6 RJZ

MEDEVAC CONFIGURATION

One (1) Bed Layout

CONFIG CONTROL NO.: MED1-RJY

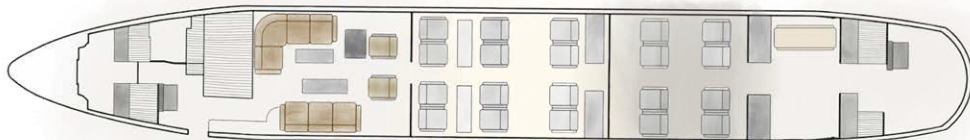

SPECIFICATIONS

EFFECTIVITY: A6 RJY

MEDEVAC CONFIGURATION

Two (2) Bed Layout

CONFIG CONTROL NO.: MED2-BBJ-A

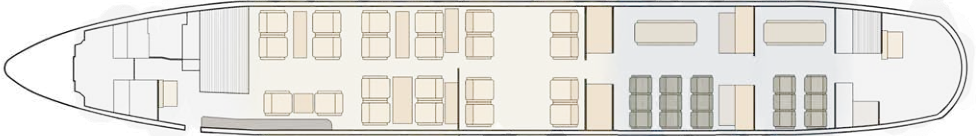

CONFIG CONTROL NO.: MED2-BBJ-B

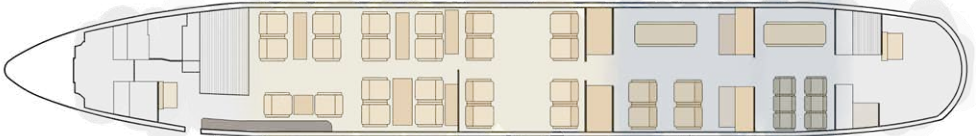

CONFIG CONTROL NO.: MED2-BBJ-C

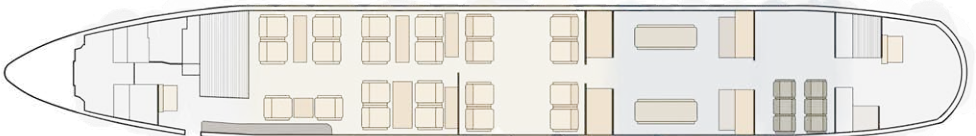

CONFIG CONTROL NO.: MED2-BBJ-D

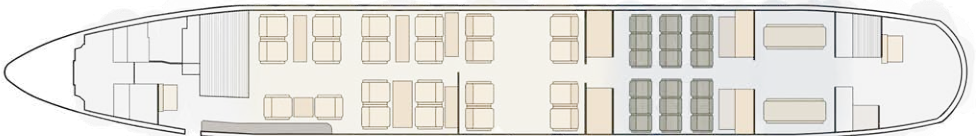

SPECIFICATIONS

EFFECTIVITY: A6 AIN, A6 DAS, A6 RJZ

MEDEVAC CONFIGURATION

Two (2) Bed Layout

CONFIG CONTROL NO.: MED2-RJY

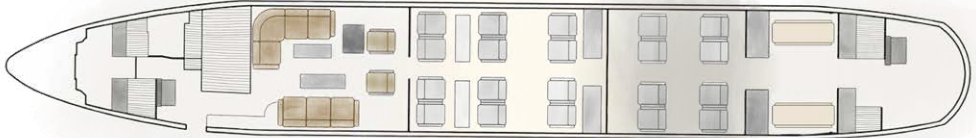

SPECIFICATIONS

EFFECTIVITY: A6 RJY



**We look forward to
welcoming you
on board soon.**

ROYALJET HEADQUARTERS

Airport Area, Next to Presidential Flight
Abu Dhabi, United Arab Emirates
info@royaljetgroup.com | +971 2 505 1520

24 HOURS SALES

sales@royaljetgroup.com | +971 2 5051 500

ROYALJETGROUP.COM